

ECO GREEN ENERGY
Building a Greener World

ATLAS by Eco Green Energy

440-460W

M10 / 182 mm Cell - 120 Half-cell

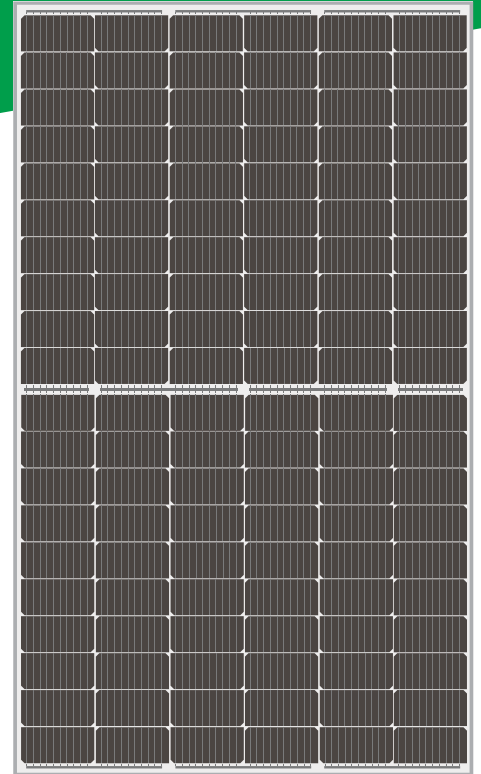

French Quality Module

Founded in 2008, Eco Green Energy is a french brand solar PV manufacturer and distributing now its PV module in more than 60 countries over the world. Atlas series solar modules are made only with grade A cells for highest power generation, lowest LCOE, and ensured more than 25 years lifespan.

KEY FEATURES



Gallium-doped Technology



Lower LCOE and BOS



Anti PID/ Low LID protection



Less Hot Spot Shading effects



Lower temperature coefficient

120-Cell

MONOCRYSTALLINE MODULE

21.25%

MAXIMUM EFFICIENCY

0~+5W

POSITIVE POWER TOLERANCE

GRADE A

CELLS GUARANTEED



LINEAR PERFORMANCE WARRANTY

12-Year Product Warranty · 25-Year Linear Power Warranty

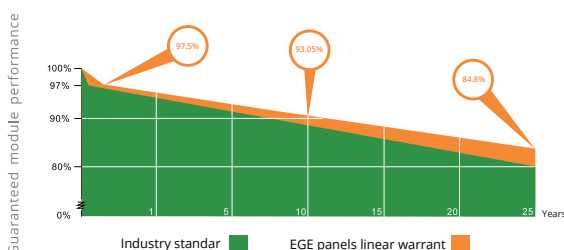

COMPREHENSIVE CERTIFICATES

IEC 61215/ IEC 61730 / IEC 61701 / IEC 62716
ISO 9001 : Quality Management Systems



ELECTRICAL DATA AT STC*

| | | | | | |
|-----------------------------|---------|---------|---------|---------|---------|
| Power output (Pmax) | 440 W | 445 W | 450 W | 455 W | 460 W |
| Power tolerance | 0~+5 W | 0~+5 W | 0~+5 W | 0~+5 W | 0~+5 W |
| Module efficiency | 20.33 % | 20.56 % | 20.79 % | 21.02 % | 21.25 % |
| Maximum power voltage (Vmp) | 33.64 V | 33.79 V | 33.94 V | 34.08 V | 34.23 V |
| Maximum power current (Imp) | 13.08 A | 13.17 A | 13.26 A | 13.35 A | 13.44 A |
| Open circuit voltage (Voc) | 40.88 V | 41.02 V | 41.17 V | 41.31 V | 41.45 V |
| Short circuit current (Isc) | 13.67 A | 13.76 A | 13.85 A | 13.94 A | 14.03 A |

*Standard Test Conditions: Irradiance: 1 000 W / m² • Cell temperature: 25°C • AM: 1.5

ELECTRICAL DATA AT NMOT*

| | | | | | |
|-----------------------------|----------|----------|----------|----------|----------|
| Power output (Pmax) | 328.08 W | 331.80 W | 335.53 W | 339.26 W | 342.99 W |
| Maximum power voltage (Vmp) | 31.54 V | 31.68 V | 31.82 V | 31.95 V | 32.09 V |
| Maximum power current (Imp) | 10.39 A | 10.46 A | 10.53 A | 10.60 A | 10.67 A |
| Open circuit voltage (Voc) | 37.91 V | 38.04 V | 38.18 V | 38.31 V | 38.44 V |
| Short circuit current (Isc) | 11.11 A | 11.19 A | 11.26 A | 11.33 A | 11.41 A |

*Nominal Operating Cell Temperature: Irradiance: 800 W / m² • Ambient temperature: 20°C • AM: 1.5 • Wind speed: 1 m/s

MECHANICAL CHARACTERISTICS

| | |
|-----------------------------|--|
| Cell type | Monocrystalline (182x91 mm) |
| Number of cells | 120 |
| Dimensions | 1909x1134x35mm (1.5mm Cell Gap) |
| Weight | 23.9 kg |
| Glass | 3.2 mm tempered glass, High transmission (>94%), Anti-Reflective Coating |
| Frame | Anodized aluminium alloy |
| Junction box | IP68 rated (3 by pass diodes) |
| Cable | 4.0mm ² ; 300mm(+) / 400mm(-) ; Length can be customized |
| Connector | MC4 or MC4 compatible |
| Max front load (e.g.: snow) | 5400 Pa |
| Max back load (e.g.: wind) | 2400 Pa |

TEMPERATURE CHARACTERISTICS

| | |
|---------------------------------|------------|
| NMOT | 45°C ±2 °C |
| Temperature coefficient of Pmax | -0.35%/°C |
| Temperature coefficient of Voc | -0.28%/°C |
| Temperature coefficient of Isc | +0.048%/°C |

MAXIMUM RATINGS

| | |
|-----------------------------|-------------------------------|
| Operating temperature range | -40 °C ~+85 °C |
| Maximum system voltage | 1500 DC (IEC) 1500 DC (UL) |
| Max series fuse rating | 25 A |

PACKAGING (1909x1134x35mm)

| | | |
|-------------------|---------|---------|
| Type | Pcs | Weight |
| Per Pallet | 31 pcs | 780 kg |
| 40ft HQ Container | 744 pcs | 18.72 t |

PV MODULE : EGE-450W-120M(M10)

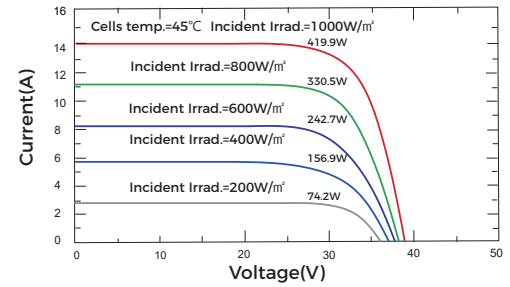

PV MODULE : EGE-450W-120M(M10)

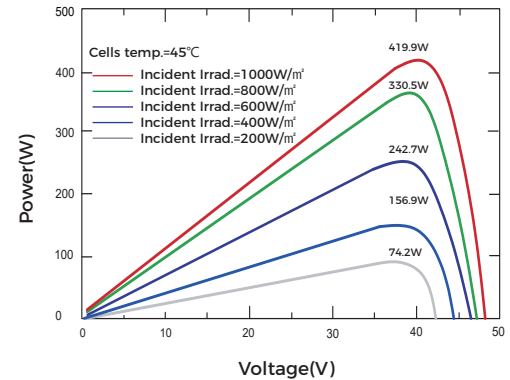

Dimension of PV Module (mm)

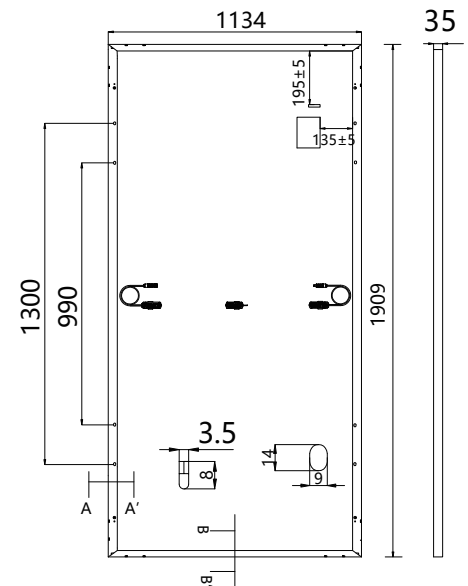

Frame Cross Section A-A

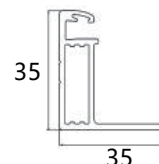

Frame Cross Section B-B

