



KEY FEATURES

Solar Cells: high efficiency solar cells ensure high performance of the solar module and create maximum power output. PID FREE.

Front: High-transmission (over 95%)3.2mm tempered glass: Back: TPT or KPF; Encapsulation: EVA.

Aluminum Frame: screw-less corner joints provide superior rigidity, ten predrilled mounting holes ease installation.

Superior Junction Box: Multi function junction box with water proof capabilities.

Under 10% decrease of output power within 10 years and 20% decrease in 25 years.

Tolerance: 0~+2%.

High impact resistance affords superior performance during severe weather-high wind, driving rain, heavy snow and hail.

Moisture proof and corrosion-resistant.

Widely used in various electric appliances and instruments in the area, such as grid net,home power system, telecommunications,illumination,transportation

SPM(SLP) 360-385 Mono 6^{inches} /72 Cells

SPM(SLP) 360-385

Allesun's photovoltaic modules are designed for large-scale electrical power requirements, with a 25 years warranty, offers high-power and reliable performance for solar projects, both on and off-grid. Anti-PID and Avoid Snail Grain. High Power Ribbon (1% more power output).

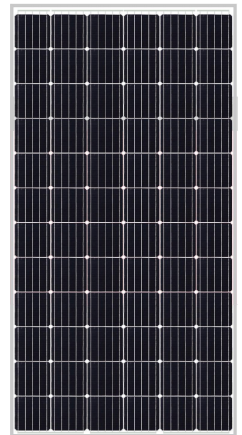

PRODUCT CERTIFICATES



Linear Power output warranty

25
YEARS

Product warranty on materials and workmanship

10
YEARS

DIMENSION OF PV MODULE

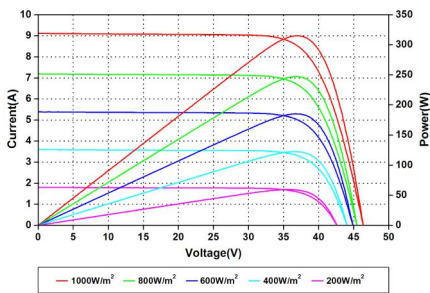
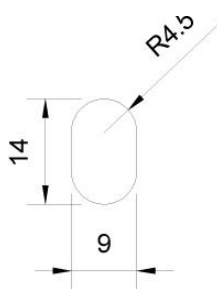
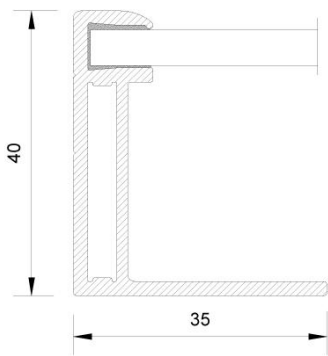
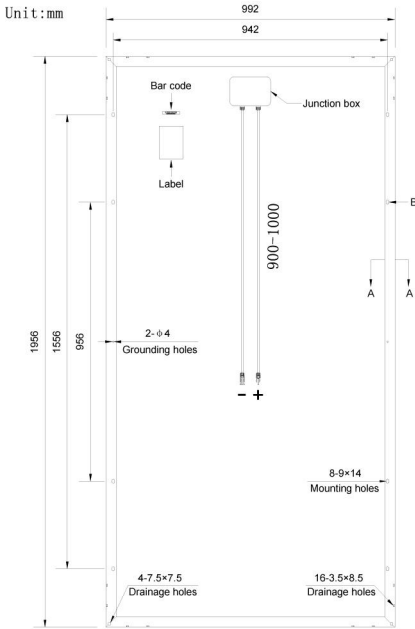

Current-Voltage and Power-Voltage Curves at Different Irradiances

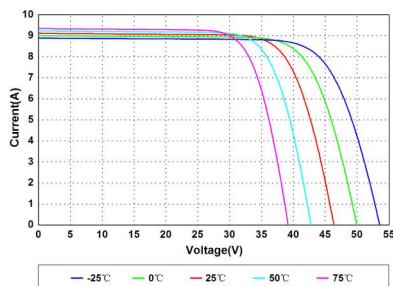

Current-Voltage Curves at Different Temperatures

Electrical Characteristics

STANDARD TEST CONDITIONS: IRRADIANCE: 1000W/M² AM: 1.5 TEMPERATURE: 25°C

Maximum Power (Pmax)	360W	365W	370W	375W	380W	385W
Maximum Power Voltage (Vmp)	39.60	39.80	39.90	40.10	40.20	40.30
Maximum Power Current (Imp)	9.10	9.18	9.28	9.36	9.46	9.56
Open Circuit Voltage (Voc)	47.60	47.70	47.80	47.90	48.00	48.10
Short Circuit Current (Isc)	9.63	9.72	9.81	9.87	9.94	10.01
Module Efficiency (%)	18.55	18.81	19.06	19.32	19.58	19.84

Temperature Coefficients

Temperature Coefficients of Pm	-0.45%/°C
Temperature Coefficients of Voc	-0.34%/°C
Temperature Coefficients of Isc	+0.05%/°C

Max. Limits

Maximum System Voltage	1000V and 1500V applicable(high cost)
Module Operating Temperature	-40°C to +86°C
Noct	45°C±2 °C

Mechanical Characteristics

Cell Technology and size	156.75mmx156.75mm(6 inches)Mono-crystal silicon
Number of Cells (pcs)	72(6x12)
Dimensions	1956x992x40mm
Weight	22.1 kgs
Frame	Anodized Aluminum Alloy
Length of Cables (mm)	900 mm (cable length can be customized)
Allowable Hail Load	227g steel ball dropped from 1m height
Surface Maximum Load Capacity	5400pa

Packaging configuration

Modules per pallet	26-28pcs
Modules per 20GP container	300pcs
Modules per 40HQ container	720pcs

Toll free:1 888 273 2188

E-mail: sales@allesun.com

Website: www.allesun.com