

# SolarPro

## SolarPro SPC300

**+** 0/+5 WP POSITIVE TOLERANCE

**🏠** ROOFTOP AND OFF-GRID DESIGN

**✓** HIGH QUALITY

25 year linear performance warranty  
10 year product warranty

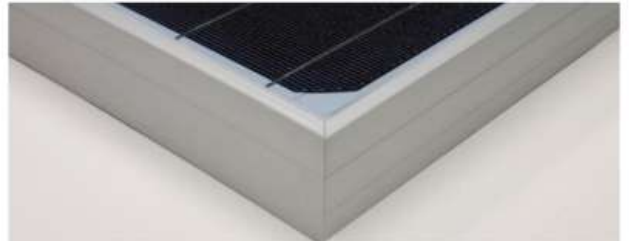

High quality solar panels designed  
for rooftop and off-grid applications



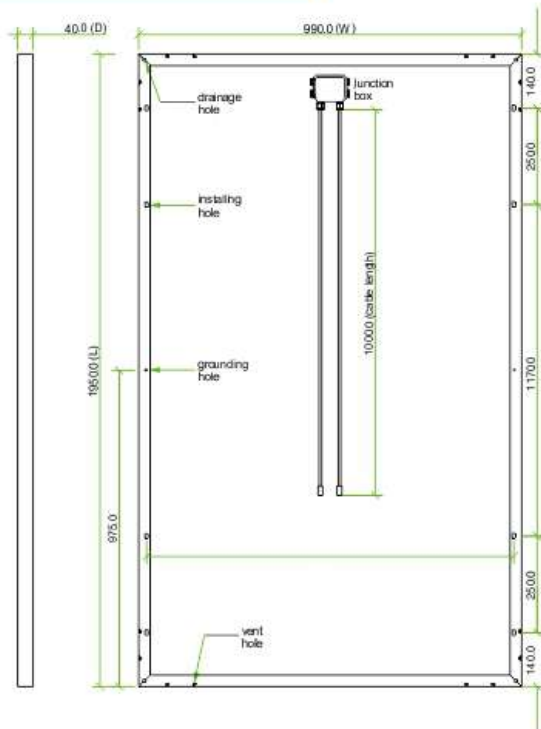

## General characteristics

Cell	monocrystalline solar cell 156 x 156 mm
No. of Cells (Connections)	72 (6x12)
Panel Dimensions	1950 x 990 x 40 mm
Weight	29.0 kg
Connectors and Cables	Connectors and 1m cables

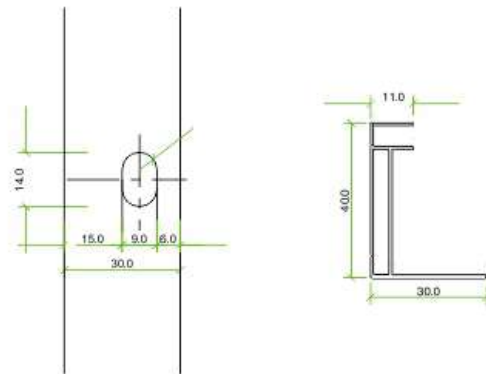

## Thermal conditions

Normal Operating Cell Temperature 800W/m Irradiance, 20°C, AM = 1.5	48°C ± 2°C
Power Temperature Coef. cient	- 0.5%/K
Current Temperature Coef. cient	0.035%/K
Voltage Temperature Coef. cient	- 0.37 MV/K

## Limits

Operating Temperature	- 40°C to 85°C
Maximum System Voltage	1000V DC

## Electric performance at STC \*

Maximum Power	300 Wp
Power Tolerance	0/+5 Wp
Module efficiency	17.46%
Maximum Power Voltage	35.8V
Maximum Power Current	8.38A
Open Circuit Voltage	44.0V
Short Circuit Current	7.05A

\*Standard Test Conditions : 1000W/m irradiance, 25°C and AM = 1.5

## High performance

**25** 25 Years  
linear performance

**10** 10 Years  
product warranty

