

# AB-72MHC

450 W  
455 W  
460 W

144 (6x24) 166x83mm 9BB

## Monocrystalline PV modules

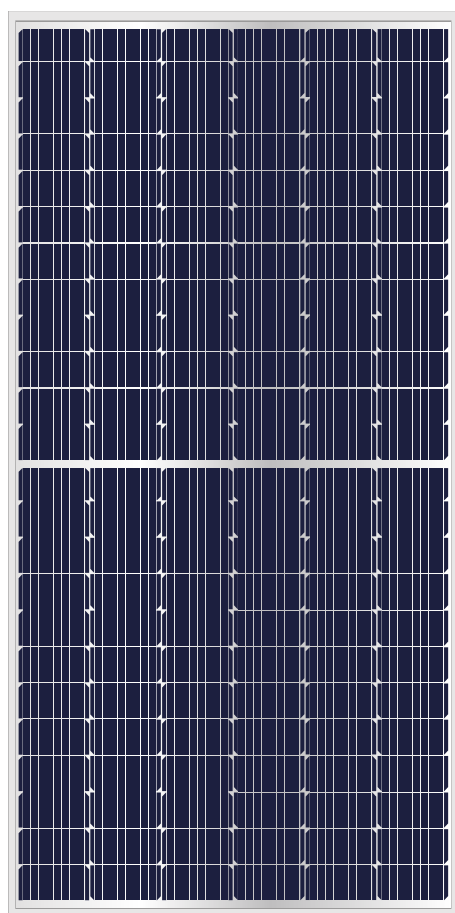

Higher output, efficiency & ROI due to reduced "Cell To Module" loss.



Modules certified by TÜV to withstand high level of wind loads (3800 Pa) and snow loads (5400 Pa)



50% Higher Yield due to better shading response



Twice Less Mismatch Loss due to double internal strings of cells.

### WHY ABI-SOLAR?

- Manufacturing and assembly of PV modules are performed only on East Asian enterprises from **Bloomberg Tier 1** list.
- PV modules are tested and demonstrate high reliability in various climatic conditions and in a wide range of insolation.
- High efficiency and return on investment guaranteed around the world.
- Modules certified by global testing facilities: IEC 61215, IEC61730, CE, ROHS, TÜV.
- Manufacturing with international quality standards and environment management system: ISO9001 and ISO14001.
- Maximum power and performance at minimal price ensure fast return of investments.
- Compatibility with both on-grid and off-grid PV systems guaranteed.

### INDUSTRY-LEADING WARRANTY BASED ON NOMINAL POWER

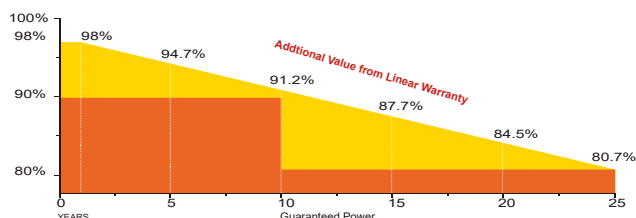

Based on nominal power (P<sub>nom</sub>)

25-year transferrable power output warranty:

94,7% - 5 years; 87,7% - 15 years; 80,7% - 25 years

12-year material and workmanship

12

YEAR

Manufacturing Warranty

12

YEAR WARRANTY

90% Power Output

25

YEAR WARRANTY

80.7% Power Output

# AB-72MHC

## MECHANICAL DRAWINGS

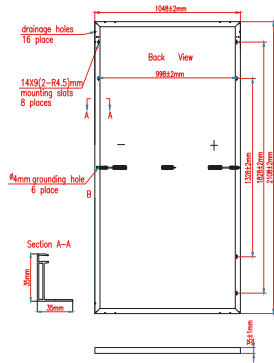

## MECHANICAL SPECIFICATIONS

Cell type	Mono crystalline
Dimensions (A×B×C)	2108×1048×35 mm
Weight	24.0 kg
Frame	Anodized aluminium alloy
Junction	IP68
Connector	MC4 Compatible
Output cables	400mm (or Customized Length)/ 4.0 mm <sup>2</sup>
Maximum snow load (IEC 61215)	5400Pa

## ELECTRICAL CHARACTERISTICS (STC)

	AB450-72MHC	AB455-72MHC	AB460-72MHC
Maximum Power (Pmax)	450W	455W	460W
Shot Circuit Current (Isc)	11.55A	11.64A	11.74A
Open Circuit Voltage (Voc)	49.8V	49.9V	50.0V
Maximum Power Current (Imp)	10.98A	11.07A	11.17A
Maximum Power Voltage (Vmpp)	41.0V	41.1V	41.2V
Module Efficiency	20.37%	20.60%	20.82%
Power Tolerance		0~+5W	
Maximum System Voltage		1500 V(TUC)	
Maximum Series Fuse		20A	

## NOCT

	AB450-72MHC	AB455-72MHC	AB460-72MHC
Maximum Power (Pmax)	335.1W	338.8W	342.5W
Shot Circuit Current (Isc)	9.38A	9.45A	9.53A
Open Circuit Voltage (Voc)	46.02V	46.11V	46.20V
Maximum Power Current (Imp)	8.64A	8.71A	8.79A
Maximum Power Voltage (Vmpp)	38.78V	38.87V	38.97V

STC irradiance: 1000 W/m<sup>2</sup> module temperature: +25 °C AM=1.5 NOCT irradiance: 800 W/m<sup>2</sup> module temperature: +20 °C AM=1.5

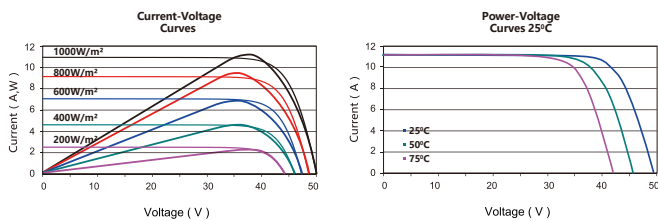

## TEMPERATURE CHARACTERISTICS

Nominal Operating Cell Temperature (NOCT)	43±2 °C
Temperature Coefficient of Pmax	-0,36 %/°C
Temperature Coefficient of Voc	-0,33 %/°C
Temperature Coefficient of Isc	0,049% /°C
Operating Temperature	-40~+85 °C

## PACKING CONFIGURATION

	<b>2150×1120×2490 mm</b>
Container	40 HQ
Pieces per Pallet	60+2
Pallets per Container	26
Pieces per Container	704

## QUALIFICATIONS AND CERTIFICATES



Specifications are subject to change without prior notification

PL08

www.abi-solar.com