

JYHY28000G(2V800AH) is GEL battery which is manufactured with colloidal Silicon and sulfuric acid .It's featured with low self-discharge ,strong ability to recover from deep discharging, good low temperature properties

JYHY28000G(2V800AH)胶体电池采用纳米级的二氧化硅硫酸胶体技术制造,具有自放电量小,过放电恢复能力强,低温性能好的特点

Performance Characteristics 基本特性

Nominal Voltage标准电压		2V
Number of cell 单格数		1
Capacity (25°C) 容量	100HR (9.6A、1.85V)	960Ah
	20HR (42.4A、1.8V)	848Ah
	10HR (80A、1.8V)	800Ah
	1HR (470.4A、1.6V)	470.4Ah
Approx. Weight 重量		52kg (114.64bs) ± 3%
Internal resistance 内阻 (Fully charged, 25°C)		Approx. 0.25mΩ
Capacity affected by temperature (10HR) 不同温度下的 10小时率容量	40°C	102%
	25°C	100%
	0°C	85%
	-15°C	65%
The self-discharge rate is less than 3% monthly at average 25°C. For higher temperature, the time interval will be shorter. 在常温25°C度的情况下,自放率小于3%(每月), 储存温度越高,则存放时间会相应缩短		
Nominal operating temperature 标准使用温度		25°C ± 3°C (77°F ± 5°F)
Operating temperature range 使用温度范围	Discharge 放电温度: -15°C ~ 50°C (5°F ~ 122°F)	
	Charge 充电温度: -10°C ~ 50°C (14°F ~ 122°F)	
	Storage 储存温度: -20°C ~ 50°C (-4°F ~ 122°F)	
Charge (Constant Voltage) 充电电流/电压	Float 浮充使用: 2.23~2.28V/77° F/(25°C)	
	Cycle 循环使用: 2.38~2.42V/77° F/(25°C) Max Current 最大电流: 160A	
Discharging current 77° F/(25°C): 3200A (5S) 放电电流(25°C): 3200A (5秒)		
Designed floating life (20°C) 设计浮充使用寿命		15~18 years

Certificate认证



Outer dimension(mm)电池尺寸

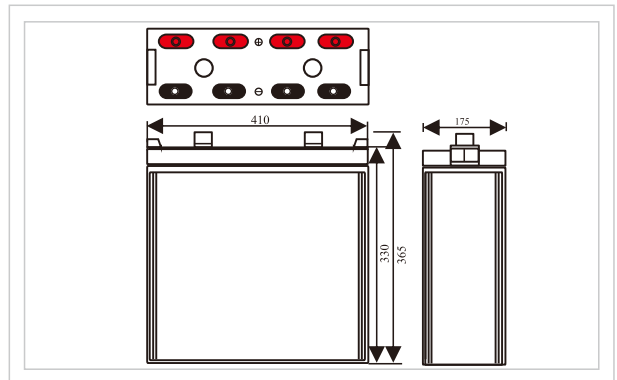

Terminal dimension(mm)端子尺寸

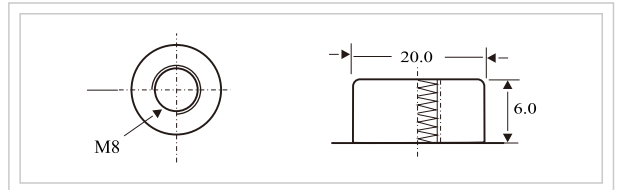

Battery Construtiion 电池结构

Terminal material 端子	Copper 铜
Positive plate 正极板	Lead dioxide 二氧化铅
Negative plate 负极板	Lead 铅
Container 胶壳	ABS
Cover 胶盖	
Safety valve 安全阀	Rubber 橡胶
Separator 隔板	Fiberglass/PE 玻璃纤维/PE
Electrolyte 电解质	Colloidal silicon 硅溶胶

Constant Current (Amp) and Constant Power (Watt) Discharge Table at 25°C (77° F) 恒流放电与恒功率放电表

F.V 终止电压	Time 时间	30min	60min	2h	3h	4h	5h	6h	8h	10h	20h	24h
		1.60V	恒流(A)	720	480	292	208	167	146	125	98	82
	恒功率(W)	1346	912	564	408	328	286	246	195	162	86	74
1.65V	恒流(A)	706	473	290	207	166	144	124	98	82	43	37
	恒功率(W)	1319	898	561	406	326	285	245	194	162	86	74
1.70V	恒流(A)	684	461	288	206	165	143	123	97	81	43	37
	恒功率(W)	1279	875	556	402	324	282	243	192	162	85	74
1.75V	恒流(A)	667	452	284	204	164	142	122	96	81	42	37
	恒功率(W)	1248	858	547	400	322	281	241	191	160	85	74
1.80V	恒流(A)	643	438	277	198	159	138	118	93	80	42	36
	恒功率(W)	1202	832	534	388	312	272	234	186	159	84	73

