

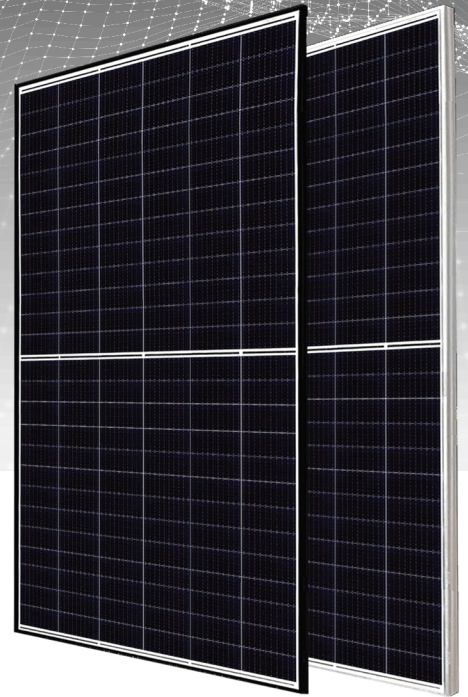

620W-630W



XP-MH78L-620W-630W X-HiPer Series

HIGH EFFICIENCY HETEROJUNCTION CELL TECHNOLOGY
The solar cells made of silicon

Comprehensive Products and System Certificates

- OHSAS 18001: Occupational Health and Safety Management System
- ISO 14001: Environmental Management System
- ISO 9001: Quality Management System



Linear Performance Warranty

- 15 YEARS** Industry Leading Product Warranty on Materials and Workmanship
- 30 YEARS** Linear Power Performance Warranty

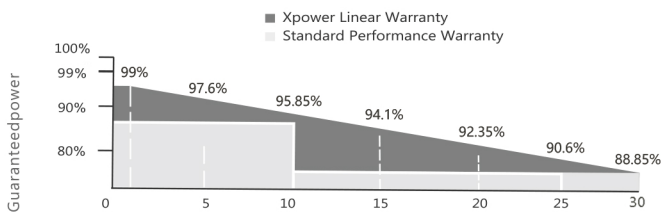

Product Insurance



Half-cut cell technology
New circuit design
lower internal current, lower Rs loss



3 times EL test to ensure best quality



Resistant to salt-spray corrosion
(IEC61701, certified to TUV Rheinland test standard)



Special circuit design
With much lower hot spot temperature



No B-O LID, excellent anti-leTID & anti-PID performance. Low power degradation, high energy yield



Special cell process ensures great performance under low irradiance conditions

XP-MH78L-620W-630W

Monocrystalline Module

DESIGN

Rear View

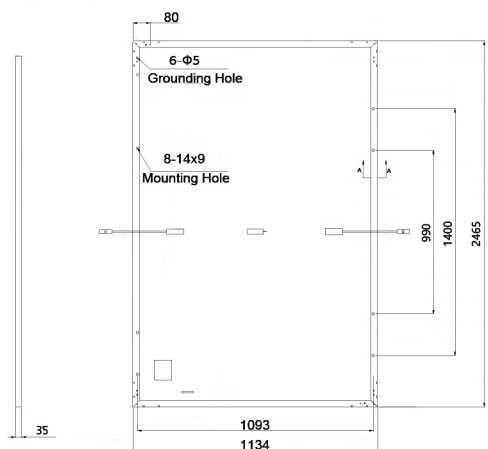

Frame Cross Section A-A

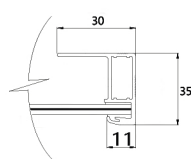

Mounting Hole

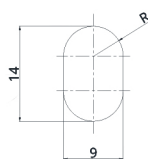

Current-Voltage & Power-Voltage Curves(630W)

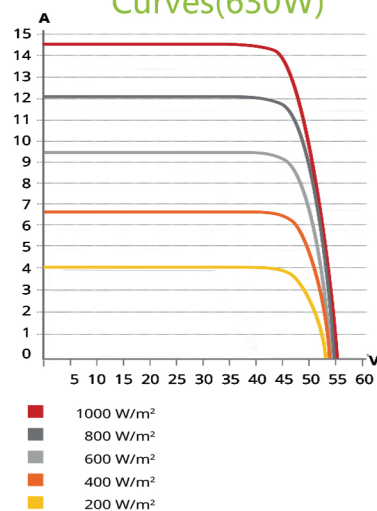

STRUCTURAL CHARACTERISTICS

Module dimensions (L*W*H)	2465 x 1134 x 35 mm
Weight	30.0 kg
Number of cells	156cells
Cell	HJT Monocrystalline 182 x 91mm
Glass	Tempered 3.2mm AR, High transmittance, Low iron
Frame	Anodized aluminium alloy
Junction box	IP68, 3 diodes
Output wire	4.0mm², wire length: 400mm
Connector	MC4 Compatible
Mechanical load	5400Pa

TEMPERFORMANCE RATINGS

Temperature coefficient (P_{max})	-0.26%/°C
Temperature coefficient (V_{oc})	-0.24%/°C
Temperature coefficient (I_{sc})	0.04%/°C
Nominal operating cell temperature	41±3°C

PACKAGING CONFIGURATION

Container	40HQ
Quantity/pallet	31
Pallets/container	18
Quantity/container	558

ELECTRIC CHARACTERISTICS

Model of modules	XP-MH78L-620W		XP-MH78L-625W		XP-MH78L-630W	
	STC	NOCT	STC	NOCT	STC	NOCT
Maximum power – P_{mp} (W)	620	465	625	469	630	473
Open-circuit voltage – V_{oc} (V)	55.4	49.6	55.5	49.7	55.6	49.8
Short-circuit current – I_{sc} (A)	14.21	11.64	14.26	11.68	14.31	11.72
Maximum power voltage – V_{mp} (V)	46.2	41.9	46.2	41.9	46.3	42.0
Maximum power current – I_{mp} (A)	13.42	11.09	13.52	11.18	13.62	11.27
Module efficiency – η_m (%)	22.18%		22.36%		22.54%	
Module efficiency w/m²	221.8W		223.6W		225.4W	
Power tolerance (W)			(0, +5)			
Maximum system voltage (V)			1500V			
Maximum rated fuse current (A)			25A			
Current operating temperature (°C)			-40°C ~ +85°C			

STC (Standard Testing Conditions): Irradiance 1000W/m², Cell Temperature 25 °C, Spectra at AM1.5

NOCT (Nominal Operating Cell Temperature): Irradiance 800W/m², Ambient Temperature 20°C, Spectra at AM1.5, Wind at 1m/S