

Half cut Mono Bi-facial Solar Module

ESM380H



RALOS
AURINKOVOIMALAT



FEATURES

- Transparent back sheet, bi-facial cells, 25% more power output
- Heavy snow load up to 5400 Pa and wind load up to 3800Pa
- IP68 junction box is available for long term weather endurance
- Salt mist, ammonia and blowing sand resistance, apply to seaside, farm and desert areas
- Selective materials and rigid process effectively control Potential Induced Degradation (PID)
- Total quality control and complete traceability of Material by Shop Floor Control (SFC)

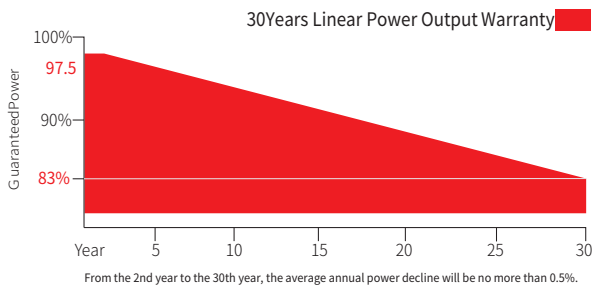

WARRANTY

- 20 Years Product Workmanship Warranty
- 12 Years Minimum 92% Power Output
- 30 Years Minimum 83% Power Output

RALOS ECO OY

VERSTAANKATU 7, LH.5
33100 TAMPERE

020 155 2222
+358 20 1552222

info@ralos.fi
www.ralos.fi

Half cut Mono crystalline Solar Module

ESM 355/360/365/370/375/380H

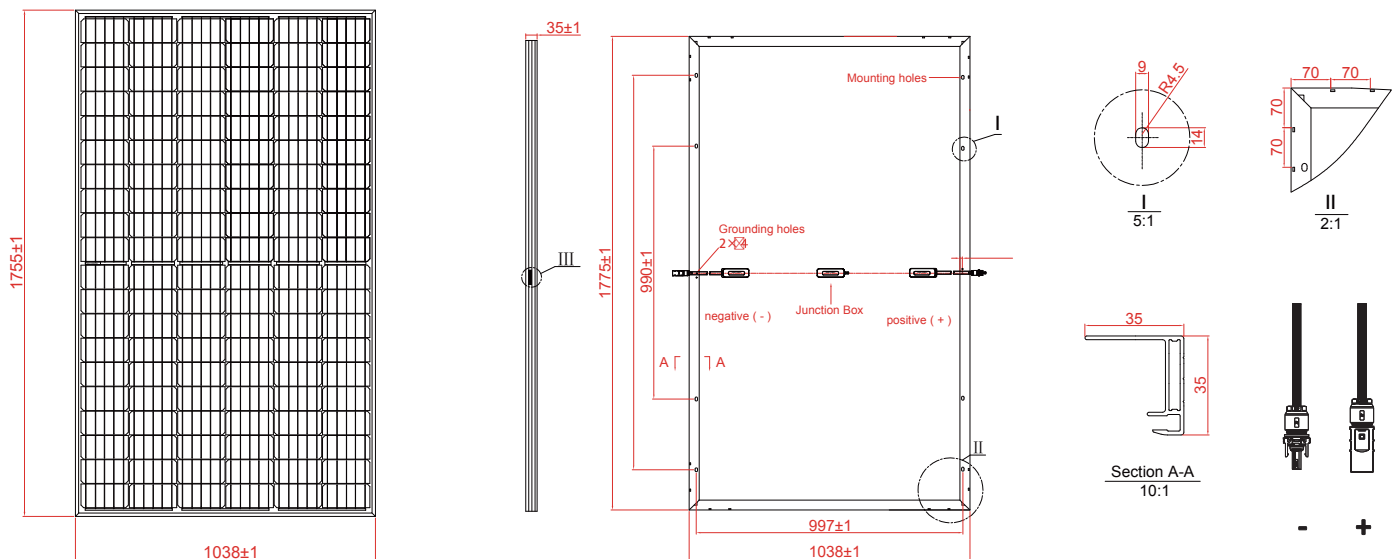

Electrical Specification

Model Type	Unit	ESM 355H	ESM 360H	ESM 365H	ESM 370H	ESM 375H	ESM 380H
Maximum Power (Pmax)	W	355	360	365	370	375	380
Module Efficiency	%	19.5	19.8	20.0	20.3	20.6	20.9
Open Circuit Voltage (Voc)	V	40.3	40.5	40.7	40.9	41.1	41.3
Short Circuit Current (Isc)	A	11.25	11.35	11.43	11.52	11.6	11.69
Maximum Power Voltage (Vmp)	V	33.8	34.0	34.2	34.4	34.6	34.8
Maximum Power Current (Imp)	A	10.51	10.59	10.68	10.76	10.84	10.92
Maximum System Voltage	V	ICE 1000VDC/UL1500(VDC)					
Maximum Series Fuse Rating	A	20					

Standard Test Conditions (STC) of irradiance of 1000 W/m², spectrum AM 1.5 and cell temperature of 25°C.

The NOCT is obtained under the Test Conditions: 800W/m², 20°C ambient temperature, AM 1.5 Spectrum, 1m/s wind speed.

Mechanical Specification

Module Dimension (mm)	1755x1038x35
Number of Cell	120
Weight (kgs)	20.5kg
Maximum Load (TUV) (Pascal)	5400
Junction Box and Cable connector	IP68 rated; MC4 compatible
Back-sheet Color	White or Black
Frame Color	Silver or Black

Temperature Characteristics

Nominal Operating Cell Temperature (NOCT)	45 +/- 2 °C
Temperature Coefficient (Pmax)	-0.35% / °C
Temperature Coefficient (Voc)	-0.29% / °C
Temperature Coefficient (Isc)	0.048% / °C
Operating Temperature	-40~85 °C

IV CURVE

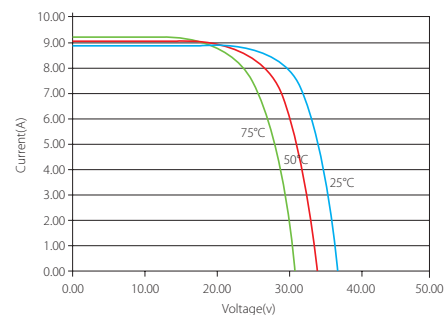
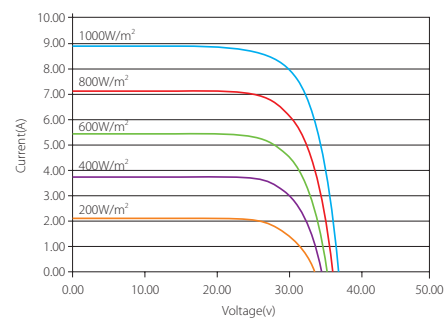

The specifications are subject to change without prior notice.