

CEC6-60P

Poly-crystalline Modules with 60 Cells

270~290W

POWER OUTPUT RANGE

16.5%~17.7%

MODULE EFFICIENCY

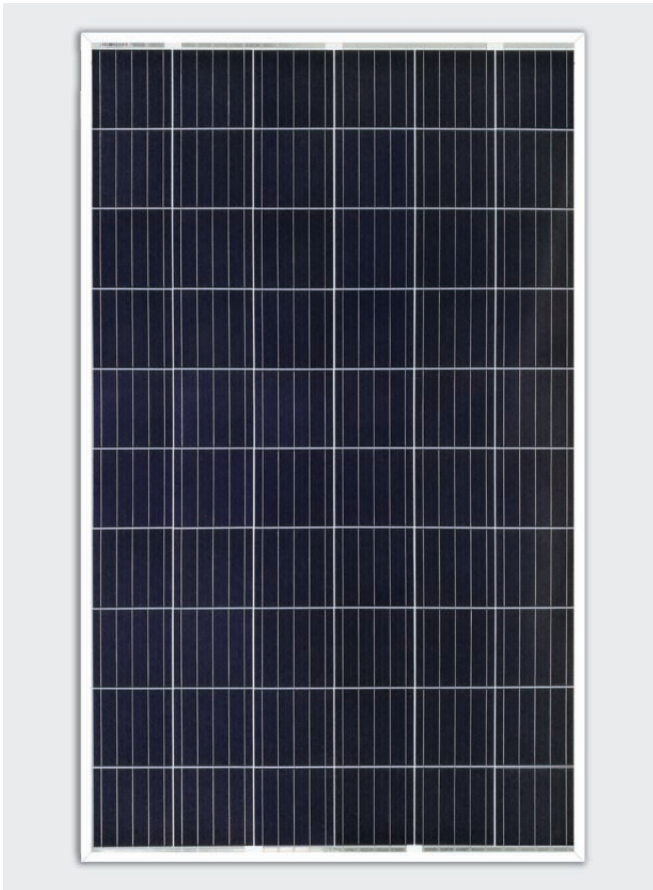

CECEP Solar Energy Technology (Zhenjiang) Co., Ltd. was established in August 2010 with a registered capital of 351million Yuan. It is the subsidiary of CECEP Solar Energy Co., Ltd.—a large size state-owned enterprise, mainly specialized in the research, manufacture and sales of crystalline silicon solar cells and modules.

 **中节能太阳能科技（镇江）有限公司**
 CECEP Solar Energy Technology (Zhenjiang) Co., Ltd.

ADD: No.9,Beishan Road,New District,Zhenjiang, jiangsu,
 China 212132

Tel: +86-511-8559 7719

Fax: +86-511-8558 7711

Web: www.cecpsolar.com

Stock code: SZ000591 太阳能



WeChat public

Product Features



Module can withstand snow pressure up to 5400Pa,
 Module can withstand wind pressure up to 2400Pa;



Guaranteed power output :0~+5W;



With high-performance in weak light conditions
 (on cloudy days, mornings and evenings);



Obtaining International independent certification
 body certifications including IEC61215, IEC61730,
 UI1703, TUV Safety ClassII, CE;



ISO9001, ISO14001 and OHSA18001 International
 Standards: Management systems of quality, environment,
 vocational health and safety

Quality Warranty

- Product materials and processes warranty for 10 years;
- No less than 90% power output within 12 years;
- No less than 80% power output within 30 years.

Linear Performance Warranty

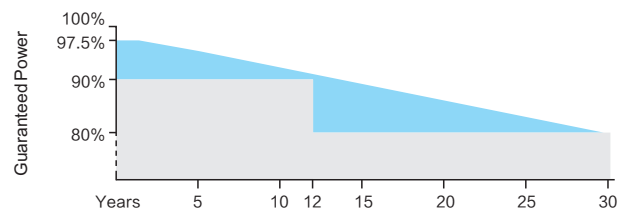

Certifications



Module Parameter

Electrical Characteristics	CEC6-60-270P/ CEC6-60-270PV	CEC6-60-275P/ CEC6-60-275PV	CEC6-60-280P/ CEC6-60-280PV	CEC6-60-285P/ CEC6-60-285PV	CEC6-60-290P/ CEC6-60-290PV
Max Power(Wp)	270	275	280	285	290
Max-Power Voltage Vmp(V)	31.04	31.29	31.47	31.71	31.87
Max-Power Current Imp(A)	8.70	8.79	8.90	8.99	9.10
Open-Circuit Voltage Voc(V)	37.66	37.91	38.16	38.40	38.63
Short-Circuit Current Isc(A)	9.31	9.42	9.53	9.64	9.75
Max-system Voltage Vdc(V)	1000/1500	1000/1500	1000/1500	1000/1500	1000/1500
Module efficiency(%)	16.5%	16.8%	17.1%	17.4%	17.7%
Power Tolerance(W)	0/+5W	0/+5W	0/+5W	0/+5W	0/+5W

All specified Parameters are at STC 25°C Ambient, 1000W/m² irradiance and AM1.5

Physical Parameter

Cell Size	156.75 × 156.75mm, 60pcs, Polycrystalline silicon (6 × 10)
Glass, Type and Thickness	High Transmission, Low Iron, Tempered Glass 3.2mm
Frame & No. of waterproof	Anodised aluminium & 20
Junction Box	IP 68 rated

Mechanical Characteristics

Dimension	1650*992*35mm
Mounting hole size	800*942, 1300*942mm
Cable Length	900mm
Weight	18.5kg

Temperature Coefficient

Nominal Module Operating Temperature (NMOT)	42°C ± 2°C
Temperature coefficient of Pmax (δ (%/°C))	-0.41
Temperature coefficient of Voc (β (%/°C))	-0.31
Temperature coefficient of Isc (α (%/°C))	0.05

Packaging Configuration

Flatcar	Pieces per case	32 pcs/case
	Quantity per pallet	2 case/pallet
40 Feet Container	Pieces per case	30 pcs/case
	Quantity per pallet	2 case/pallet
	Pieces per container	840 pcs/40' HQ

Limit Parameters

Operating temperature	-40°C to +85°C
Maximum fuse rated current	15A

Technical Drawings

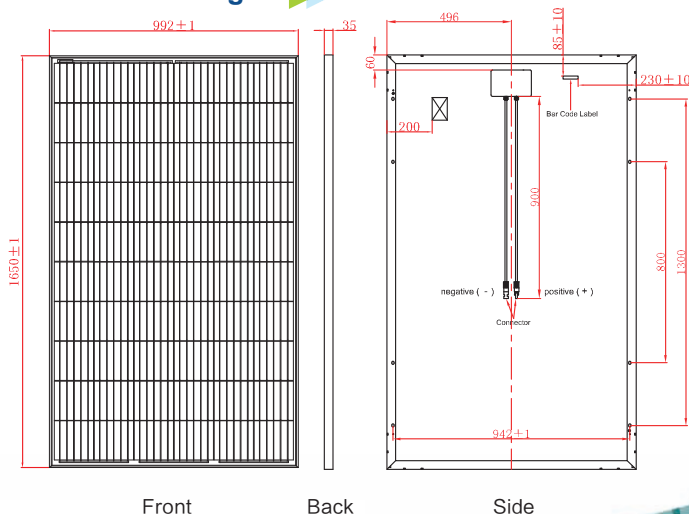

I-V Curve (270W)

