

SSF Solar Module

SSF-P72



ELECTRICAL DATA (STC)

Peak Power Watts-P _{MAX} (Wp)*	320	325	330	335
Power Output Tolerance-P _{MAX} (W)	0 ~ +5			
Maximum Power Voltage-V _{MPP} (V)	37.1	37.2	37.3	37.6
Maximum Power Current-I _{MPP} (A)	8.63	8.76	8.87	8.91
Open Circuit Voltage-V _{OC} (V)	45.8	45.9	46.1	46.3
Short Circuit Current-I _{SC} (A)	9.10	9.25	9.38	9.39
Module Efficiency η _p (%)	16.5	16.8	17.0	17.3

STC: Irradiance 1000W/m², Cell Temperature 25°C, AM1.5.
*Measuring tolerance: ±3%.

ELECTRICAL DATA (NOCT)

Maximum Power-P _{MAX} (Wp)	238	242	246	249
Maximum Power Voltage-V _{MPP} (V)	34.4	34.5	34.6	34.9
Maximum Power Current-I _{MPP} (A)	6.91	7.02	7.11	7.14
Open Circuit Voltage-V _{OC} (V)	42.5	42.6	42.7	42.9
Short Circuit Current-I _{SC} (A)	7.35	7.47	7.57	7.58

NOCT: Irradiance at 800W/m², Ambient Temperature 20°C, Wind Speed 1m/s.

COMPONENT MATERIALS

Solar Cells	Poly Crystalline 157 × 157 mm (6.18 inches)
Cell Orientation	72 cells (6 × 12)
Module Dimensions	1956 × 992 × 35 mm (77.0 × 39.0 × 1.37 inches)
Weight	22.5 kg (49.60 lb) (with 3.2 mm glass; 26.1 kg with 4.0 mm glass)
Glass	3.2 mm (0.125 inches), High Transmission, AR Coated Tempered Glass, Anti-Reflective, Low Iron, High Transmission
Backsheet	White
Frame	Silver Anodized Aluminium Alloy
J-Box	IP 68 rated - 4 Rails - 3 pcs bypass diodes
Cables	Photovoltaic Technology Cable 4.0mm ² (0.006inches ²), 1100 mm (43.3 inches)
Connector	MC4 Compatible

TEMPERATURE RATINGS

Nominal Operating Cell Temperature (NOCT)	44°C (± 2°C)
Temperature Coefficient of P _{MAX}	- 0.41%/°C
Temperature Coefficient of V _{OC}	- 0.32%/°C
Temperature Coefficient of I _{SC}	0.05%/°C

MAXIMUM RATINGS

Operational Temperature	-40~+85°C
Maximum System Voltage	1000V DC
Max Series Fuse Rating	15A

WARRANTY

- 10 year Product Workmanship Warranty
- 25 year Linear Power Warranty

(Please refer to product warranty for details)

PACKAGING CONFIGURATION

- Modules per box: 24 pieces
- Modules per 40' container: 528 pieces

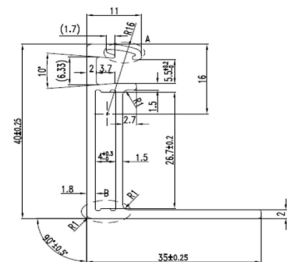
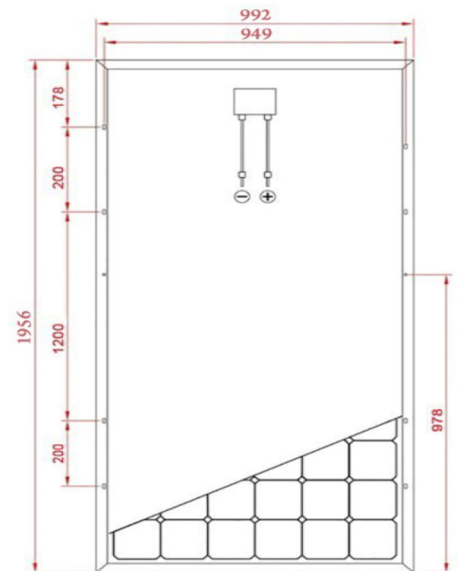

LINEAR PERFORMANCE WARRANTY

10 Year Product Warranty • 25 Year Linear Power Warranty

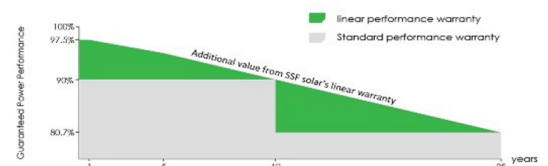

Electrical Performance & Temperature Dependence

Current-Voltage & Power-Voltage Curves (325W)

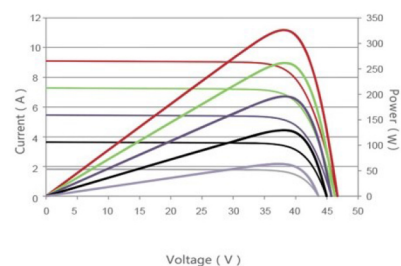

Temperature Dependence of I_{sc}, V_{oc}, P_{max}

