

# OPzV Tubular-Gel Battery

## 2V1000AH

### FEATURES

- Low self-discharge and long shelf life
- Non-Spillable construction
- Safety valve installation for explosion proof
- Exceptional deep discharge recovery performance
- 99.7% pure lead calcium grids and A recognized Component of U.L

### APPLICATION

- Photovoltaic system
- Telecommunications
- Emergency Power System
- Power plant and power transformer system
- Control Equipment



### SPECIFICATIONS

|                             |  |
|-----------------------------|--|
| Nominal Voltage             | 2V   |
| Nominal Capacity            | 1000Ah@10 hour rate F.V.(1.80V/cell)   |
| Approx. Weight              | 77Kg   |
| Terminals                   | M8 Female Large Size Copper Post   |
| Internal Resistance         | ≤0.33mΩ (Fully Charged)  |
| Max. Discharge Current      | 20000A (3 sec)   |
| Max. Charge Current         | 250A   |
| Operating Temperature Range | Charge: -20°C~50°C (-4°F~122°F)<br>Discharge: -40°C~55°C (-40°F~131°F)<br>Storage: -20°C~40°C (-4°F~104°F) |
| Self Discharge              | About 2.0% of capacity declined per month at (25°C)  |

ISO 9001 IAF

通信产品认证

- IEC 60896-21/22
- DIN 40742
- YD/T 1360-2005

### DIMENSION(mm/inch)

### OUTER DIMENSIONS

### TERMINAL TYPE

#### Length

233±2.0mm (9.32±0.08inch)

#### Width

210±2.0mm (8.40±0.08inch)

#### Container Height

646±2.0mm (25.84±0.08inch)

#### Total Height

678±2.0mm (27.12±0.08inch)

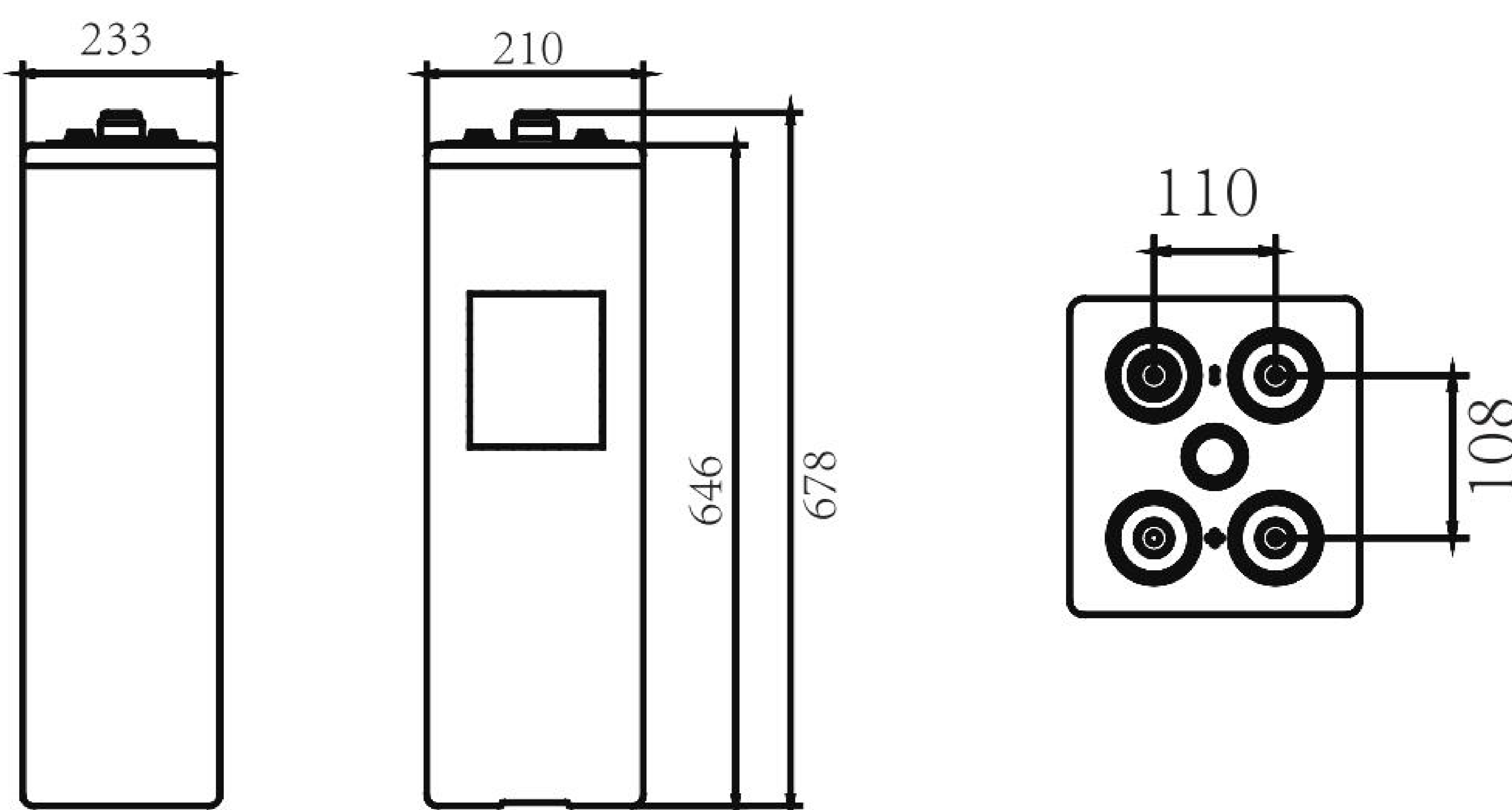

#### Terminal

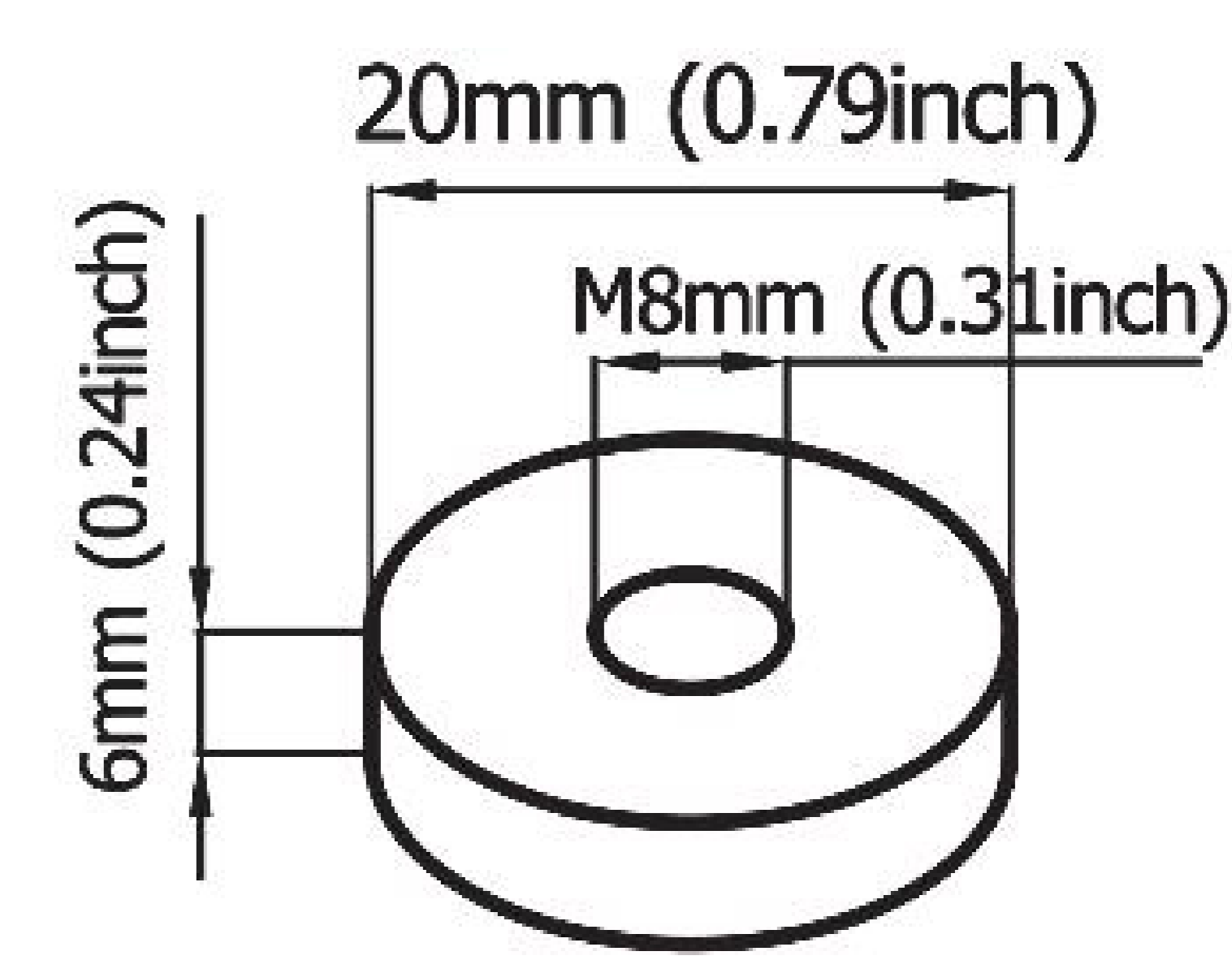

[M8 BOLT]

Terminal Hardware Initial Torque:13(5.5Nm±5%)

### Constant power discharge characteristics at 25°C/77°F Unit:W

| F.V/Time | 15MIN  | 30MIN  | 1HR    | 2HR   | 3HR   | 5HR   | 10HR  | 20HR  |
|----------|--------|--------|--------|-------|-------|-------|-------|-------|
| 1.70V    | 1827.5 | 1487.5 | 1152.5 | 677.5 | 533.8 | 366.3 | 197.5 | 112.1 |
| 1.75V    | 1682.5 | 1427.5 | 1105.0 | 660.0 | 521.3 | 361.3 | 195.0 | 110.4 |
| 1.80V    | 1490.0 | 1342.5 | 973.8  | 642.5 | 502.5 | 355.0 | 192.5 | 110.3 |
| 1.90V    | 1107.5 | 998.8  | 793.8  | 590.0 | 441.3 | 320.0 | 172.5 | 102.0 |

| Charge Voltage |                   |
|----------------|-------------------|
| Cycle use      | 2.35-2.40V (±4mV) |
| Max Current    | 250A              |

### Constant current discharge characteristics at 25°C/77°F Unit:A

| F.V/Time | 15MIN  | 30MIN | 1HR   | 2HR   | 3HR   | 5HR   | 10HR  | 20HR |
|----------|--------|-------|-------|-------|-------|-------|-------|------|
| 1.70V    | 1060.0 | 860.0 | 585.0 | 357.5 | 265.0 | 177.5 | 102.5 | 58.0 |
| 1.75V    | 940.0  | 802.5 | 560.0 | 347.5 | 260.0 | 176.3 | 101.3 | 57.6 |
| 1.80V    | 820.0  | 700.0 | 520.0 | 332.5 | 250.0 | 173.8 | 100.0 | 57.4 |
| 1.90V    | 520.0  | 490.0 | 390.0 | 275.0 | 215.0 | 155.0 | 88.8  | 52.6 |

| Float Use         |
|-------------------|
| 2.25-2.30V (±3mV) |



# OPzV Tubular-Gel Battery

## 2V1000AH

### Trickle(or Float) Service Life

### Charge Characteristic

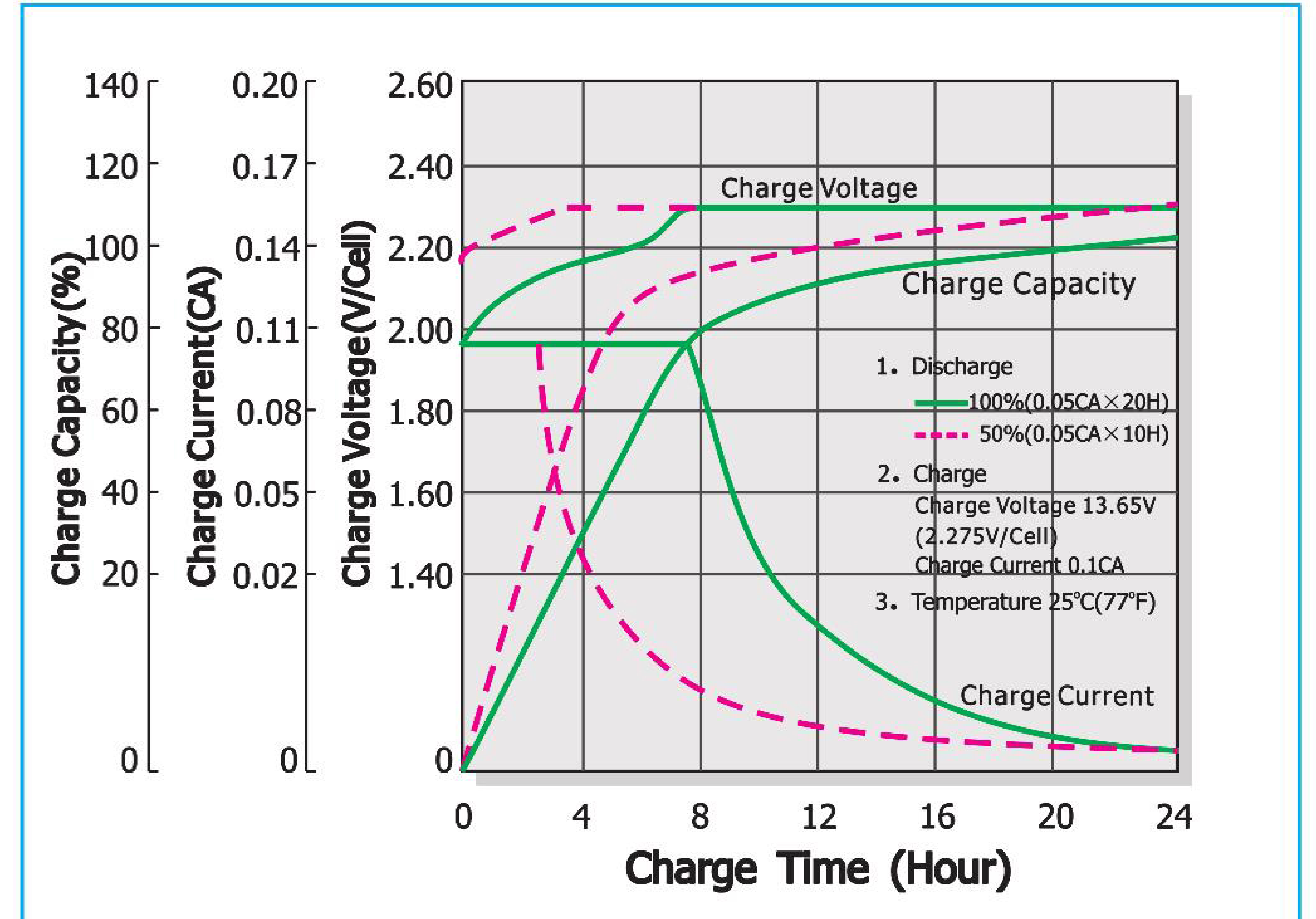
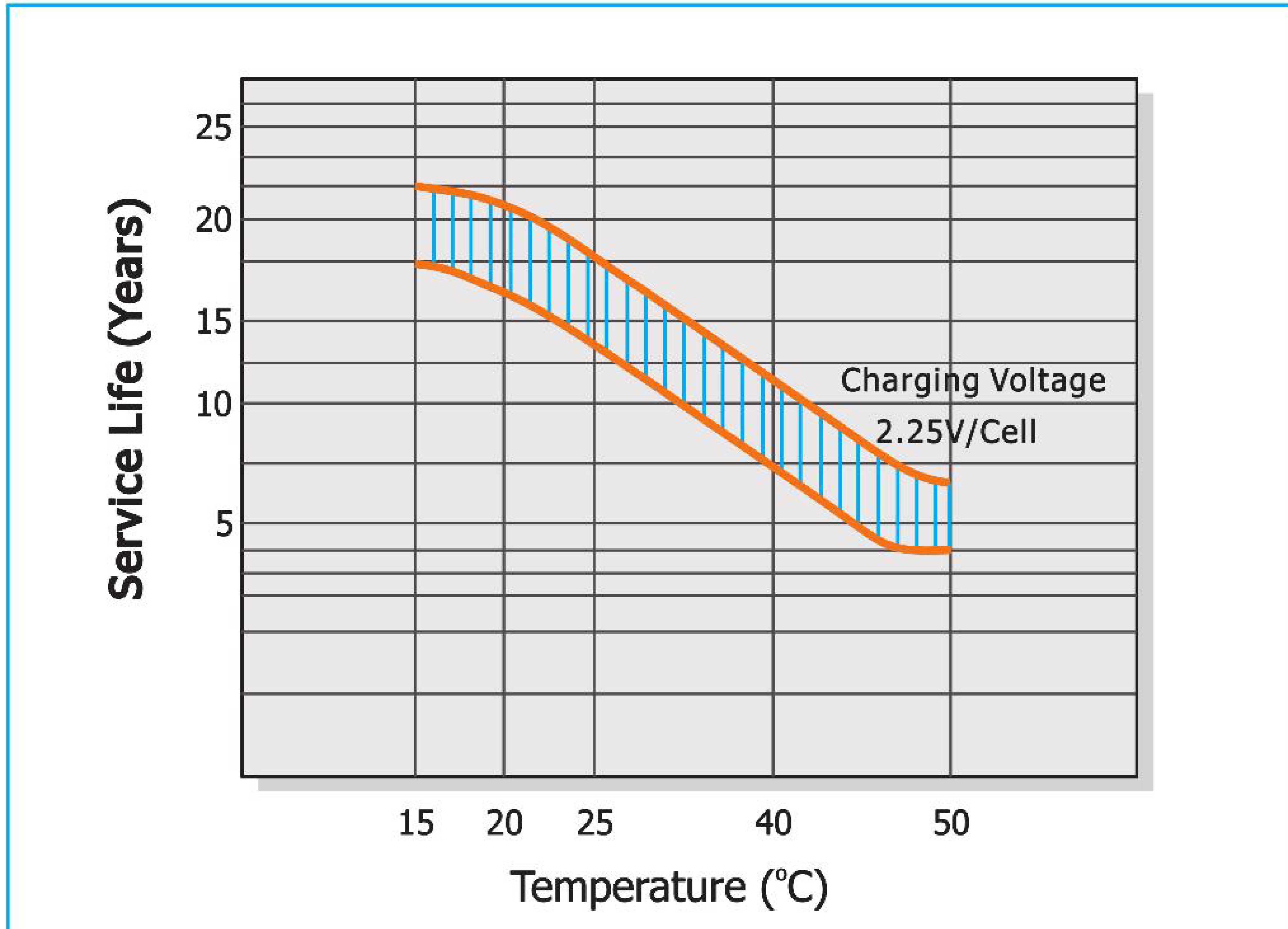

### Cycle Service Life

### Discharge Characteristic

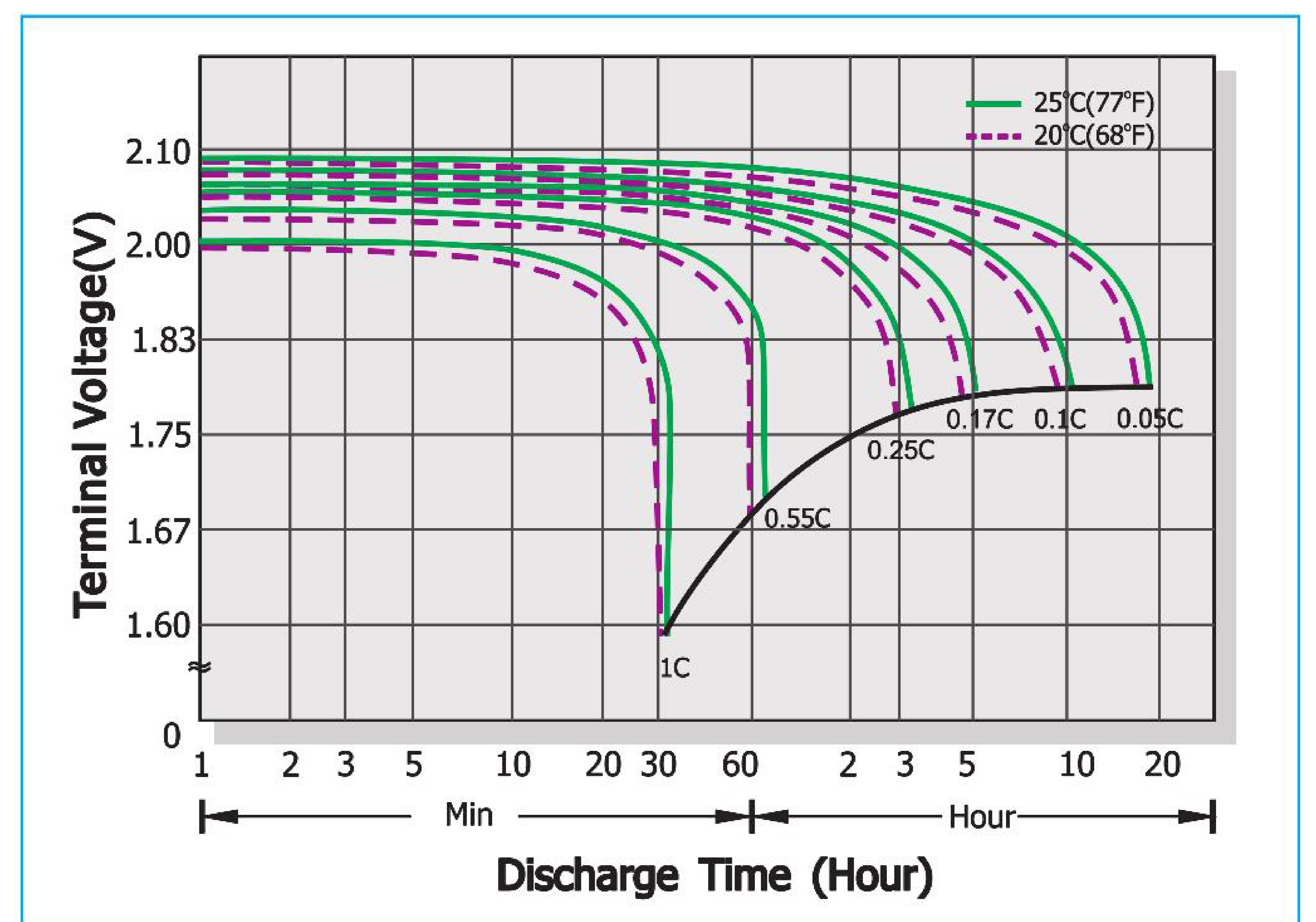
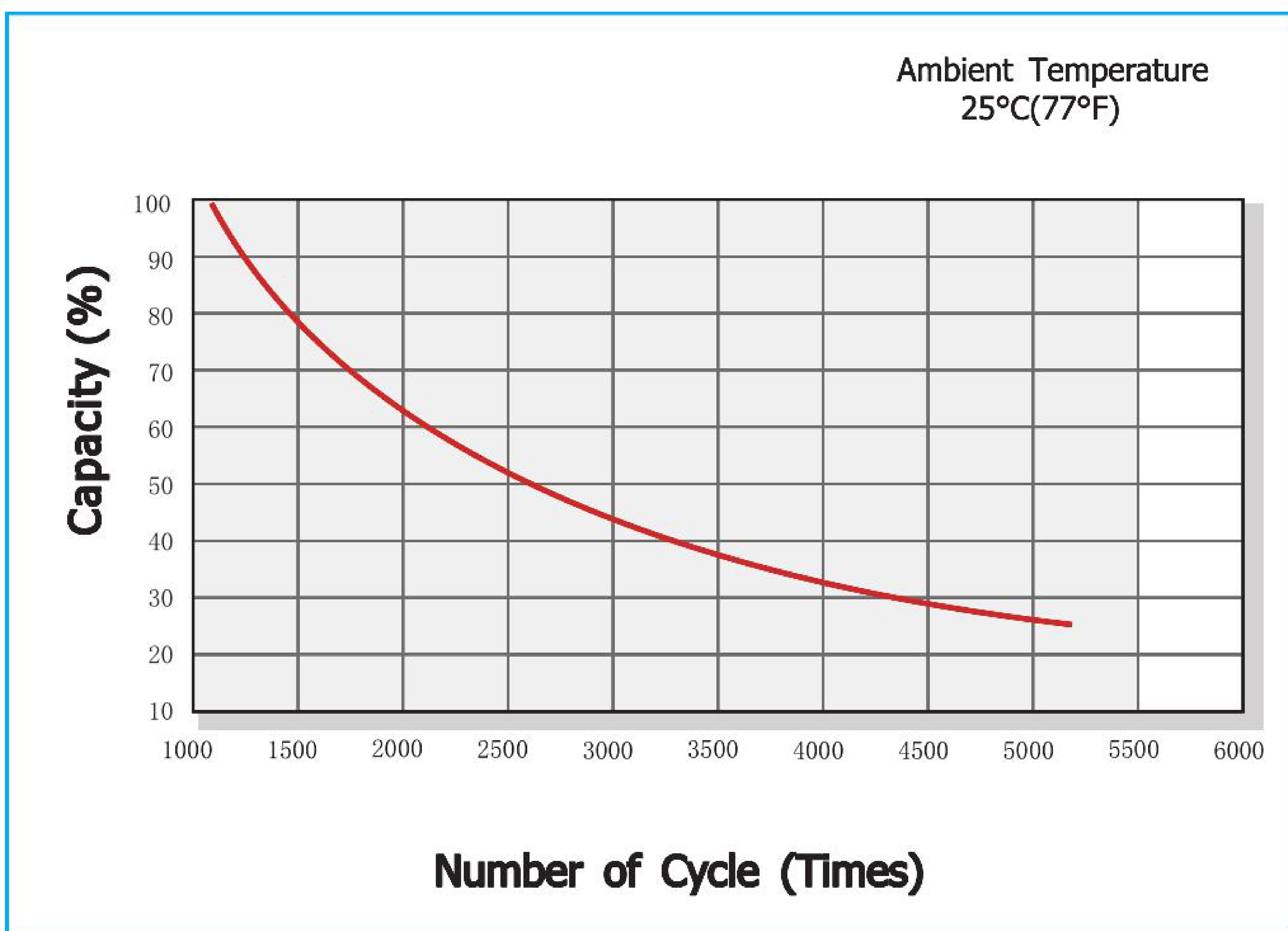

### Capacity Factors With Different Temperature

| Battery Type |        | -20°C | -10°C | 0°C | 5°C | 10°C | 20°C | 25°C | 30°C | 40°C | 45°C |
|--------------|--------|-------|-------|-----|-----|------|------|------|------|------|------|
| GEL Battery  | 6V&12V | 55%   | 75%   | 85% | 88% | 90%  | 98%  | 100% | 102% | 104% | 105% |
|              | 2V     | 65%   | 80%   | 88% | 90% | 92%  | 99%  | 100% | 103% | 105% | 106% |
| AGM Battery  | 6V&12V | 46%   | 66%   | 76% | 83% | 90%  | 98%  | 100% | 103% | 107% | 109% |
|              | 2V     | 55%   | 70%   | 80% | 85% | 92%  | 99%  | 100% | 104% | 108% | 110% |