

The rechargeable batteries are lead-lead dioxide systems. The dilute sulfuric acid electrolyte is absorbed by separators and plates and thus immobilized. Should the battery be accidentally overcharged producing hydrogen and oxygen, special one-way valves allow the gases to escape thus avoiding excessive pressure build-up. Otherwise, the battery is completely sealed and is, therefore, maintenance-free, leak proof and usable in any position.

Battery Construction

| | | | | | | | | |
|--------------|----------------|----------------|-----------|-------|--------------|----------|------------|---------------|
| Component | Positive plate | Negative plate | Container | Cover | Safety valve | Terminal | Separator | Electrolyte |
| Raw material | Lead dioxide | Lead | ABS | ABS | Rubber | Copper | Fiberglass | Sulfuric acid |

General Feature

- Absorbent Glass Mat(AGM) technology for efficient gas recombination of up to 99% and freedom from electrolyte maintenance or water adding.
- Not restricted for air transport-complies with IATA/ICAO Special Provision A67.
- UL-recognized component.
- Can be mounted in any orientation.
- Computer designed lead, calcium tin alloy grid for high power density.
- Long service life, float or cyclic applications.
- Maintenance-free operation.
- Low self discharge.

Performance Characteristics

| | | |
|---|---|--------|
| Capacity 77°F(25°C) | 20 hour rate (2.9A、 10.8V) | 58Ah |
| | 10 hour rate (5.5A、 10.8V) | 55Ah |
| | 5 hour rate (9.6A、 10.5V) | 48Ah |
| | 1 hour rate (35.2A、 9.6V) | 35.2Ah |
| Internal Resistance | Full charged Battery77°F(25°C):8mΩ | |
| Capacity affected by Temperature (10 hour rate) | 104° F(40°C) | 102% |
| | 77° F(25°C) | 100% |
| | 32° F(10°C) | 85% |
| | 5° F(-15°C) | 65% |
| Self-Discharge 68°F(20°C) | Capacity after 3 month storage | 90% |
| | Capacity after 6 month storage | 80% |
| | Capacity after 12month storage | 60% |
| Max. discharge current77°F(25°C): 550A(5S) | | |
| Charge (Constant Voltage) | Float: 13.6~13.8 V/77° F(25°C) | |
| | Cycle:14.4~14.7 V/77°F(25°C) Max. Current: 13.8A | |

SPECIFICATION

- Nominal voltage 12V
- Number of cell 6
- Length(mm/inch) 229/9.01
- Width(mm/inch) 138/5.43
- Height(mm/inch) 208/8.19
- Total Height(mm/inch) 212/8.35
- Approx. Weight(kg/lbs) 16.5/36.4

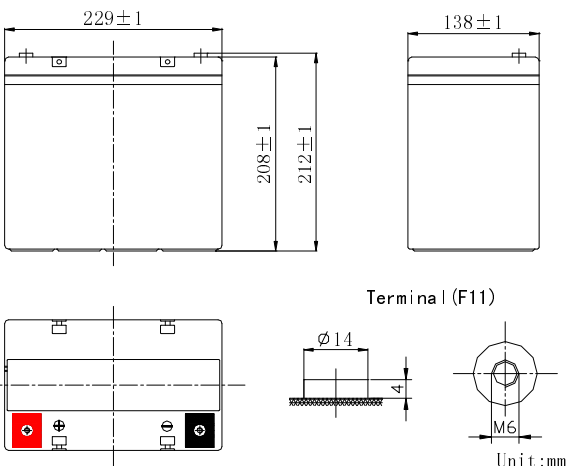

Discharge Constant Current (Amperes at 77° F25 °C)

| End Point Volts/Cell | 5min | 10min | 15min | 30min | 1h | 3h | 5h | 10h | 20h |
|----------------------|------|-------|-------|-------|------|------|------|------|------|
| 1.60V | 172 | 130 | 98.0 | 58.2 | 35.2 | 14.5 | 9.98 | 5.66 | 2.95 |
| 1.65V | 162 | 123 | 94.0 | 56.5 | 34.4 | 14.3 | 9.88 | 5.63 | 2.94 |
| 1.70V | 152 | 115 | 89.5 | 54.5 | 33.6 | 14.0 | 9.75 | 5.59 | 2.93 |
| 1.75V | 141 | 108 | 84.4 | 52.9 | 32.7 | 13.7 | 9.60 | 5.55 | 2.92 |
| 1.80V | 128 | 100 | 50.5 | 51.0 | 31.6 | 13.4 | 9.43 | 5.50 | 2.90 |

Discharge Constant Power (watts at 77° F 25 °C)

| End Point Volts/Cell | 5min | 10min | 15min | 30min | 45min | 1h | 2h | 3h | 5h |
|----------------------|------|-------|-------|-------|-------|------|------|------|------|
| 1.60V | 330 | 247 | 191 | 115 | 88.4 | 71.4 | 42.5 | 30.1 | 19.4 |
| 1.65V | 310 | 233 | 183 | 113 | 87.1 | 69.8 | 41.7 | 29.5 | 19.3 |
| 1.70V | 291 | 220 | 176 | 111 | 85.3 | 68.2 | 40.8 | 28.9 | 18.8 |
| 1.75V | 271 | 207 | 168 | 109 | 83.4 | 66.6 | 39.8 | 28.3 | 18.7 |
| 1.80V | 257 | 192 | 159 | 107 | 81.2 | 64.9 | 38.8 | 27.7 | 18.5 |

(Note)The above characteristics data are average values obtained Within three charge/discharge cycles not the minimum values.

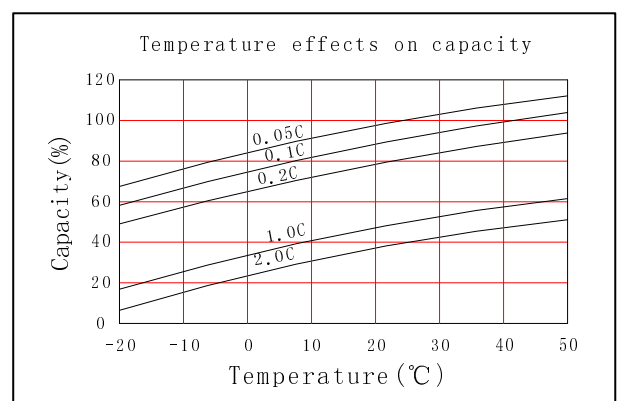
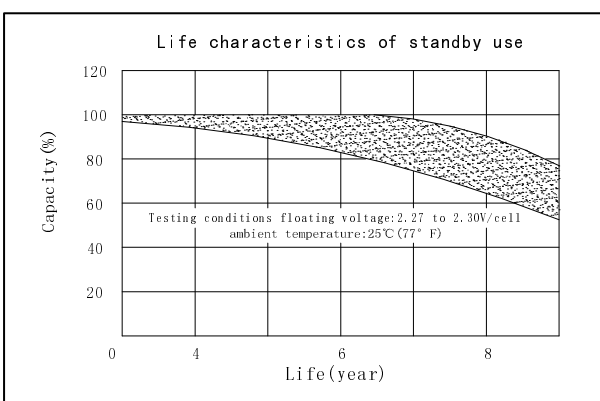
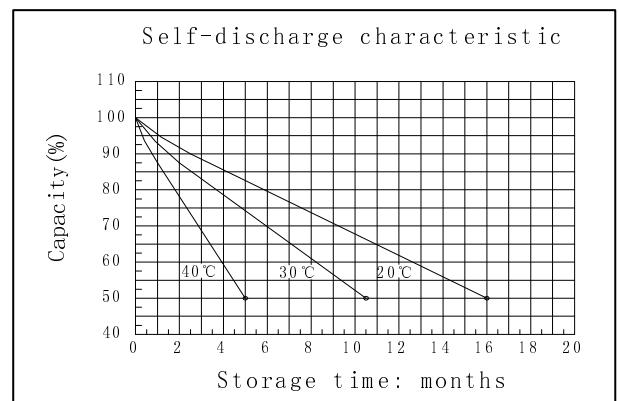
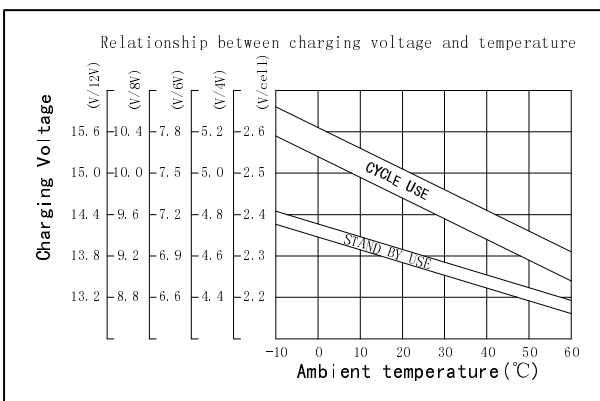
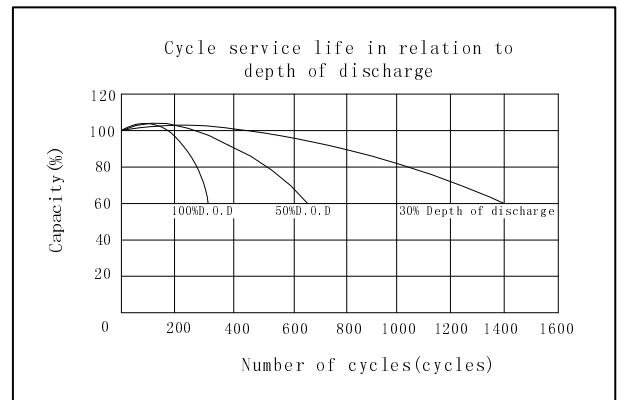
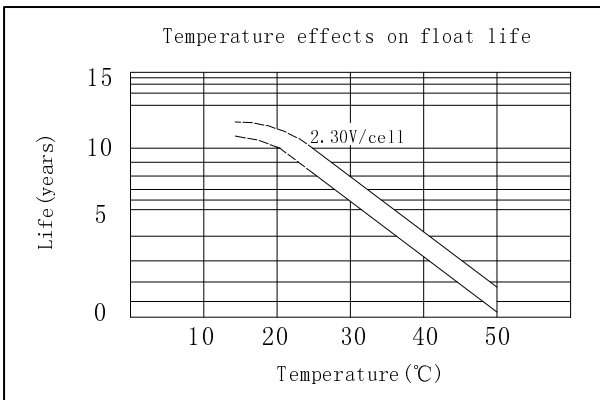
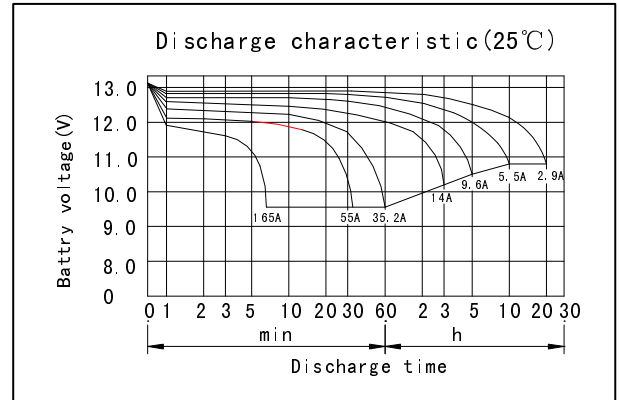
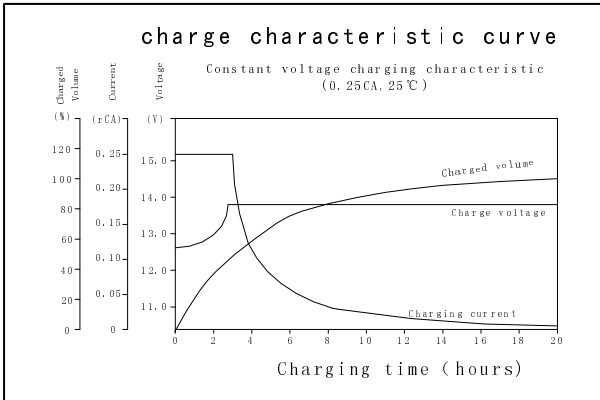

GREAT POWER BATTERY TECHNOLOGY CO.,LTD

Address: Longguan 1st Road, LongHua Town, BaoAn District, Shenzhen, China.

TEL. 86-755-2900 8403 Fax: 86-755-3386 3366

Email: info@greatpowerbattery.com Http:// www.greatpowerbattery.com