

# TWINSEL

HIGH PERFORMANCE  
MONOCRYSTALLINE PERC MODULE

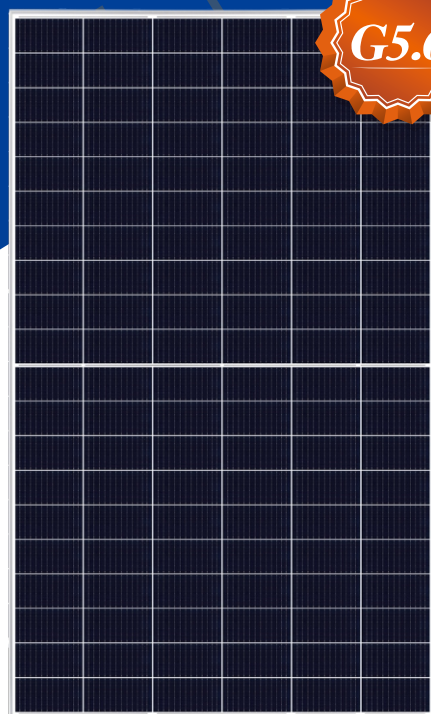

**G5.6**

## RSM120-8-580M-600M

**120 CELL**

Mono PERC Module

**580-600Wp**

Power Output Range

**1500VDC**

Maximum System Voltage

**21.2%**

Maximum Efficiency

### KEY SALIENT FEATURES



Global, Tier 1 bankable brand, with independently certified state-of-the-art automated manufacturing



Industry leading lowest thermal co-efficient of power



Excellent low irradiance performance



Excellent PID resistance



Positive tight power tolerance



Dual stage 100% EL Inspection warranting defect-free product



Module Imp binning radically reduces string mismatch losses



Excellent wind load 2400Pa & snow load 5400Pa under certain installation method



Comprehensive product and system certification

- ◆ IEC61215:2016; IEC61730-1/-2:2016;
- ◆ ISO 9001:2015 Quality Management System
- ◆ ISO 14001:2015 Environmental Management System
- ◆ ISO 45001:2018 Occupational Health and Safety Management System

## Dimensions of PV Module

Unit: mm

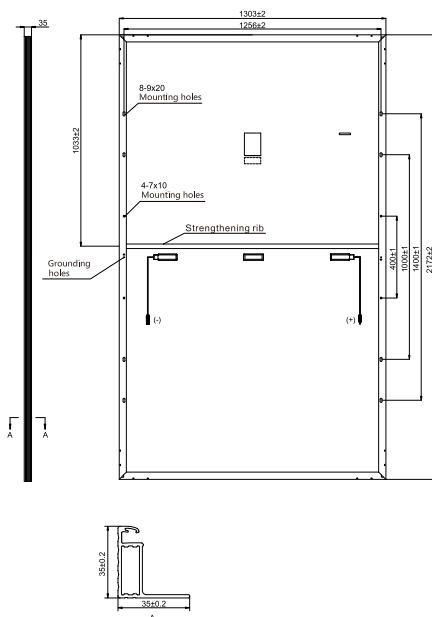

## ELECTRICAL DATA (STC)

Model Number	RSM120-8-580M	RSM120-8-585M	RSM120-8-590M	RSM120-8-595M	RSM120-8-600M
Rated Power in Watts-Pmax(Wp)	<b>580</b>	<b>585</b>	<b>590</b>	<b>595</b>	<b>600</b>
Open Circuit Voltage-Voc(V)	40.80	41.00	41.20	41.40	41.60
Short Circuit Current-Isc(A)	18.11	18.16	18.21	18.26	18.32
Maximum Power Voltage-Vmpp(V)	33.94	34.12	34.32	34.50	34.70
Maximum Power Current-Imp(A)	17.10	17.15	17.20	17.25	17.30
Module Efficiency (%) *	20.5	20.7	20.8	21.0	21.2

STC: Irradiance 1000 W/m<sup>2</sup>, Cell Temperature 25°C, Air Mass AM1.5 according to EN 60904-3.

\* Module Efficiency (%): Round-off to the nearest number

## ELECTRICAL DATA (NMOT)

Model Number	RSM120-8-580M	RSM120-8-585M	RSM120-8-590M	RSM120-8-595M	RSM120-8-600M
Maximum Power-Pmax (Wp)	439.5	443.1	447.0	450.7	454.6
Open Circuit Voltage-Voc (V)	37.94	38.13	38.32	38.50	38.69
Short Circuit Current-Isc (A)	14.85	14.89	14.93	14.97	15.02
Maximum Power Voltage-Vmpp (V)	31.50	31.66	31.85	32.02	32.20
Maximum Power Current-Imp (A)	13.95	13.99	14.04	14.08	14.12

NMOT: Irradiance at 800 W/m<sup>2</sup>, Ambient Temperature 20°C, Wind Speed 1 m/s.

## MECHANICAL DATA

Solar cells	Monocrystalline
Cell configuration	120 cells (6×10+6×10)
Module dimensions	2172×1303×35mm
Weight	31.5±0.5kg
Superstrate	High Transmission, Low Iron, Tempered ARC Glass
Substrate	White Back-sheet
Frame	Anodized Aluminium Alloy type 6005-2T6, Silver Color
J-Box	Potted, IP68, 1500VDC, 3 Schottky bypass diodes
Cables	4.0mm <sup>2</sup> (12AWG), Positive(+)350mm, Negative(-)350mm (Connector Included)
Connector	Risen Twinsel PV-SY02, IP68

## TEMPERATURE & MAXIMUM RATINGS

Nominal Module Operating Temperature (NMOT)	44°C±2°C
Temperature Coefficient of Voc	-0.25%/°C
Temperature Coefficient of Isc	0.04%/°C
Temperature Coefficient of Pmax	-0.34%/°C
Operational Temperature	-40°C~+85°C
Maximum System Voltage	1500VDC
Max Series Fuse Rating	30A
Limiting Reverse Current	30A

## PACKAGING CONFIGURATION

	40ft(HQ)
Number of modules per container	527
Number of modules per pallet	31
Number of pallets per container	17
Packaging box dimensions (LxWxH) in mm	1350×1145×2310
Box gross weight[kg]	1020

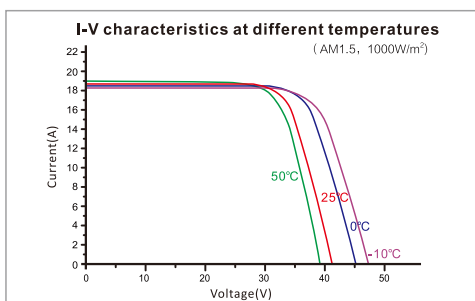
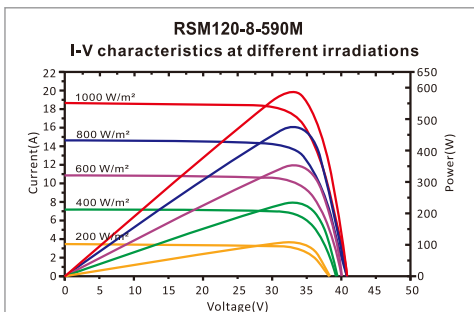

### Our Partners: