

# AB-60MHC

120 (6x20) 182mmx91mm

455W  
460W  
465W  
470W

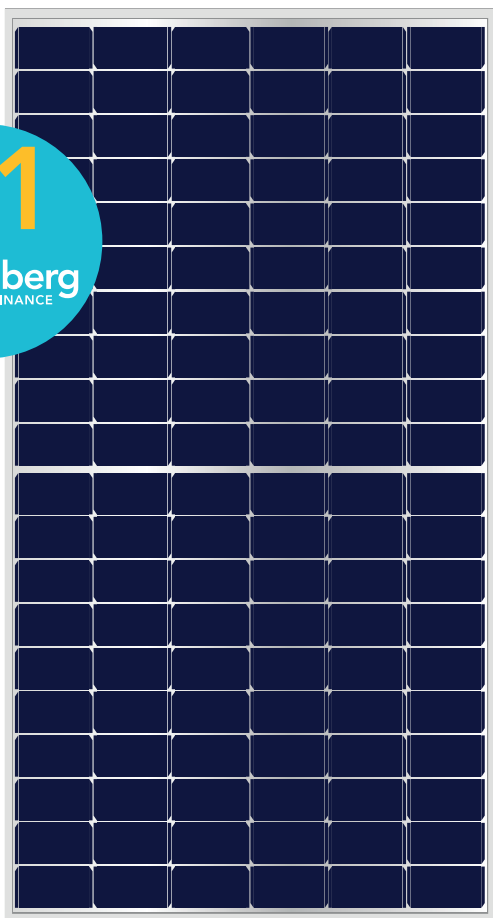

Power tolerance (0~+4.99%) to ensure the high reliability of power output



Modules certified by TÜV to with stand high level of wind loads (2400 Pa) and snow loads (5400 Pa)



Special PV Module Insurances by world leading insurance company guarantees the benefit of PV investors and PV module users



Junction box and bypass diods guarantee the modules free of overheating and "hot spot effect"

## WHY ABI-SOLAR?

- Manufacturing and assembly of PV modules are performed only on East Asian enterprises from **Bloomberg Tier 1** list.
- PV modules are tested and demonstrate high reliability in various climatic conditions and in a wide range of insolation.
- High efficiency and return on investment guaranteed around the world.
- Modules certified by global testing facilities: IEC61215, IEC61730, CE, ROHS, TÜV.
- Manufacturing with international quality standarts and environment management system: ISO9001, ISO14001 and OHSAS18001.
- Maximum power and performance at minimal price ensure fast return of investments.
- Compatability with both on-grid and off-grid PV systems ga-teared.

## INDUSTRY-LEADING WARRANTY BASED ON NOMINAL POWER

12

YEAR

Manufacturing Warranty

25

YEAR WARRANTY

83.1% Power Output

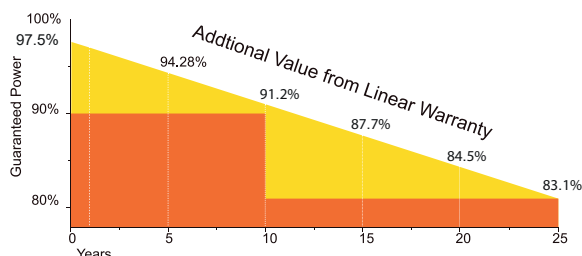

## MECHANICAL DRAWINGS

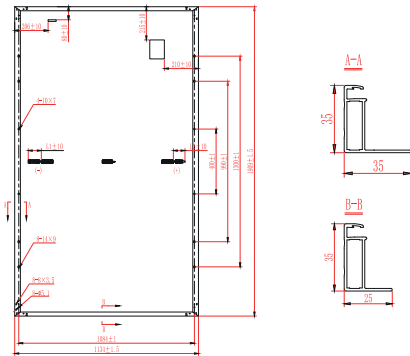

## MECHANICAL SPECIFICATIONS

Cell type	Perc Mono crystalline
Number of cell	120(2x20)
Dimensions (AxBxC)	1909x1134x35mm
Weight	23.0 kg
Font glass	High transmission tempered glass
Frame	Anodized aluminium alloy
Junction Box	IIP68
Connector	MC4 / MC4 Compatible
Output cables	4mm <sup>2</sup> (IEC) Length
Maximum snow load (IEC 61215)	5400Pa

## ELECTRICAL CHARACTERISTICS (STC)

	AB455-60MHC	AB460-60MHC	AB465-60MHC	AB470-60MHC
Maximum Power (Pmax)	455W	460W	465W	470W
Shot Circuit Current (Isc)	13.97A	14.04A	14.11A	14.18A
Open Circuit Voltage (Voc)	41.48V	41.63V	41.78V	41.93V
Maximum Power Current (Imp)	13.04A	13.13A	13.22A	13.30A
Maximum Power Voltage (Vmpp)	34.93V	35.08V	35.23V	35.38V
Module Efficiency	21.0%	21.2%	21.5%	21.7%
Power Tolerance	(0~+5W)			
Maximum System Voltage	1500V DC(IEC)			
Maximum Series Fuse	25A			

## NOCT

	AB455-60MHC	AB460-60MHC	AB465-60MHC	AB470-60MHC
Maximum Power (Pmax)	338W	342W	346W	350W
Shot Circuit Current (Isc)	11.27A	11.33A	11.39A	11.44A
Open Circuit Voltage (Voc)	39.31V	39.46V	39.60V	39.74V
Maximum Power Current (Imp)	10.21A	10.29A	10.36A	10.44A
Maximum Power Voltage (Vmpp)	33.11V	33.25V	33.39V	33.53V

STC irradiance: 1000 W/m<sup>2</sup> module temperature: +25 °C AM=1.5 NOCT irradiance: 800 W/m<sup>2</sup> module temperature: +20 °C AM=1.5

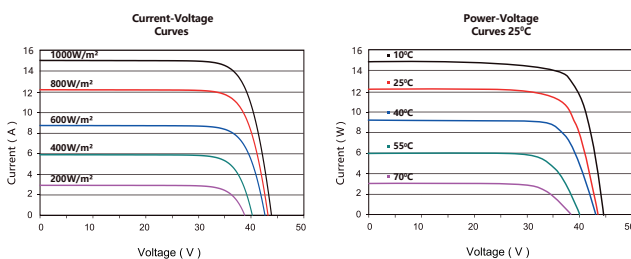

## TEMPERATURE CHARACTERISTICS

Nominal Operating Cell Temperature (NOCT)	45±2 °C
Temperature Coefficient of Pmax	-0,39 %/°C
Temperature Coefficient of Voc	-0,29 %/°C
Temperature Coefficient of Isc	0,049 %/°C
Operating Temperature	-40~+85 °C

## PACKING CONFIGURATION

	1909×1134×35mm
Container	40'HQ
Pieces per Pallet	31
Pallets per Container	16
Pieces per Container	744

## QUALIFICATIONS AND CERTIFICATES

