

**2R15/150**  
**2R20/150**

| Dati tecnici<br>Technical data                  | 2R15/150    | 2R20/150    |
|-------------------------------------------------|-------------|-------------|
| Camera di lavoro (mm)<br>Shredding chamber (mm) | 1500 X 1100 | 1960 X 1100 |
| Lame da 75 mm (n.)<br>75 mm blades (no.)        | 20          | 26          |
| Lame da 50 mm (n.)<br>50 mm blades (no.)        | 30          | 40          |
| Potenza (kW)<br>Power (kW)                      | 110         | 110         |
| Tensione (V)<br>Voltage (V)                     | 220/400/460 | 220/400/460 |
| Peso (kg)<br>Weight (kg)                        | 10000+2180  | 11500+2180  |

# Dati Tecnici/Technical Data

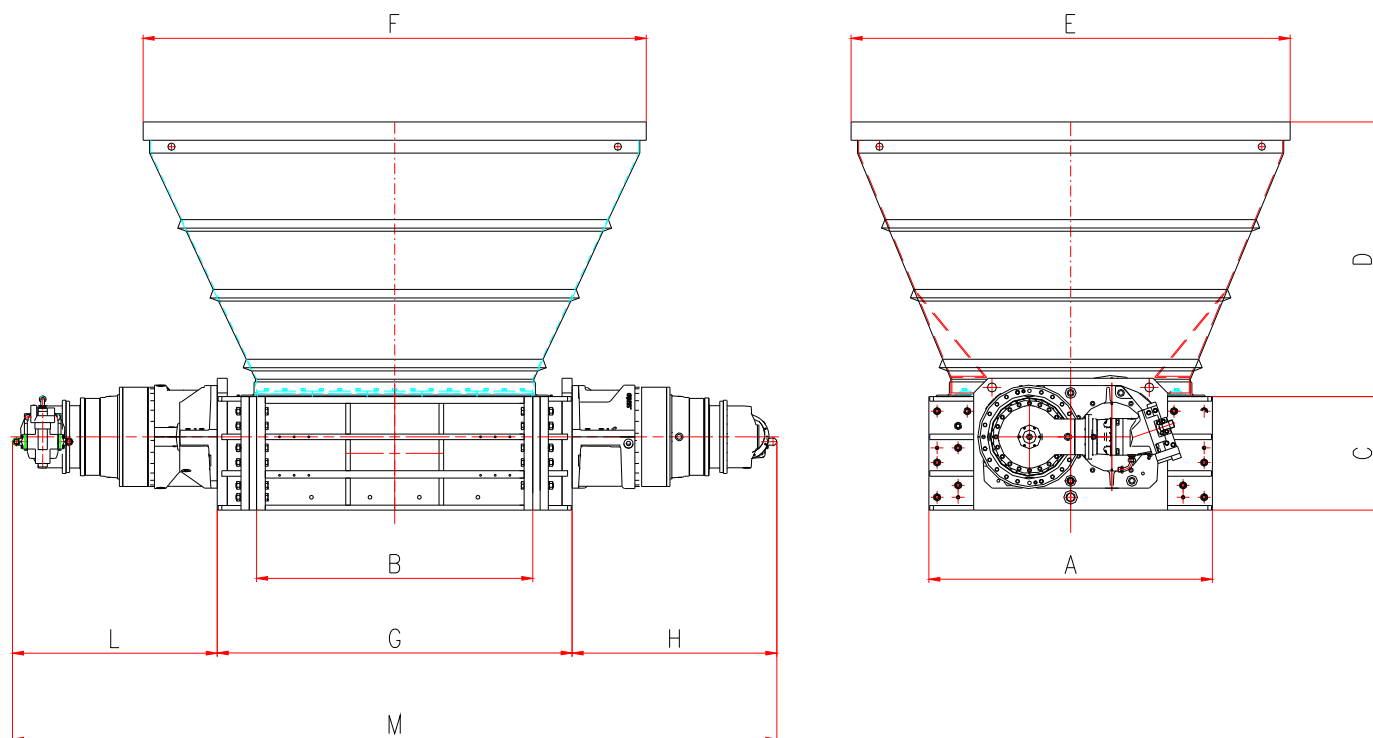

## Esempi di materiali trattati / Some applications:

|                                              |                                                                                     |             |
|----------------------------------------------|-------------------------------------------------------------------------------------|-------------|
| Rifiuti solidi urbani<br><i>Urbane waste</i> |  | 10 ÷ 20 t/h |
| Fusti metallici<br><i>Steel drums</i>        |  | 180 pcs/h   |
| Pneumatici<br><i>Tyres</i>                   |  | 4 ÷ 6 t/h   |
| Rifiuti ingombranti<br><i>Bulk waste</i>     |  | 4 ÷ 6 t/h   |

|          | 2R15/150 | 2R20/150 |
|----------|----------|----------|
| <b>A</b> | 1550     | 1550     |
| <b>B</b> | 1510     | 1960     |
| <b>C</b> | 620      | 620      |
| <b>D</b> | 1500     | 1500     |
| <b>E</b> | 2400     | 2400     |
| <b>F</b> | 2770     | 3220     |
| <b>G</b> | 1940     | 2390     |
| <b>H</b> | 1076     | 1076     |
| <b>L</b> | 1076     | 1076     |
| <b>M</b> | 4092     | 4542     |

CAT1012 Rev. A 04/15

## SatrindTech S.r.l.

Via Monfalcone, 122 - 20010 Arluno (MI) - Italy

Tel. (+39) 02 90376683

Fax (+39) 02 90376721

info@satrindtech.com

www.satrindtech.com

